

Aviation

TABLE OF CONTENTS

TRACER AV2	16
<i>Base Assembly</i>	

Tracer AV2

Base Assembly



Part Number/Price

Ref #	Part #	Description	Price
1	202088	Enclosure, Tracer AV2 CPU Box	Consult
2	202089	Cover, Tracer AV2 CPU Box	Consult
3	206442	Screw, M3-0.5x10 Phillips Pan Head Zinc Finish Steel External Tooth Washer SEMS	Consult
4	202140	Screw, M4-0.7x10 Phillips Pan Head Zinc Finish Steel External Tooth Washer SEMS	Consult
5	194219	Screw, M4x0.7 X 10 Phillips Drilled Cheese Head SST	Consult
6	203731	Connector, USB A to B Micro Panel	Consult
7	207172	Ribbon Cable, 14 Position 1.0 mm Pitch, 5.98 Inch Fpc	Consult
8	208686	Cable Assembly, RJ45 Jack to 4 Position Connector	Consult
9	203773	Cable Assembly, Power Harness, 2 Position, 2.5 mm Barrel Jack	Consult
10	112228	Cable, RF UFL to RSMA, 6 Inch Length	Consult
11	203827	Bracket, Tracer AV2 Wall Mount	Consult
12	204340	Cable Assembly, Dual Remote Displays, Dual Female DB-9 Connectors	Consult
13	204341	Cable Assembly, Serial, Male DB-9 Connector	Consult
14	204342	Cable Assembly, Load Cell, Female DB-9 Connector	Consult
15	193108	Setup Switch Assembly, Remote	Consult
16	180861	Screw, M5x0.8x10 mm Slotted Drilled Cheese Head SST	Consult
17	98357	Antenna, 2.4 GHz 802.11b/g	Consult
18	15134	Washer, Lock No 8 Type A Internal Tooth Steel Zinc Plated	Consult
19	15140	Washer, Lock No 10 Type A Internal Tooth	Consult
20	207163	Label, Tracer AV2 I/O	Consult
21	201805	Board Assembly, 5 Button Keypad Adapter Board, Male DB-9 Connector	Consult
22	203733	Cable, USB Micro-B Male to Micro-B Male, 4 Inch	Consult
23	201638	Board Assembly, CPU Tracer AV2 Indicator, ROHS	Consult
24	15704	Connector, Mounting Kit D-Sub Chassis Mounting Hardware	Consult
-	205206	Assembly, Tracer AV2 CPU Box Airline Kiosk	Consult
-	207288	Kit, RD2 LCD Display Panel Mount	Consult
-	207289	Kit, RD2 LCD Display External Mount	Consult
-	207290	Kit, Single 5 Button Keypad	Consult
-	207292	Kit, Dual 5 Button Keypad	Consult
-	207302	Cable, RS-232 Splitter, DB-9 Female to Two DB-9 Male Connectors	Consult
-	50749	Cable, DB-9 Female to DB-9 Female, Straight Through Wired	Consult
-	15438	Power cord, detachable, 7.5 ft long	Consult
-	203937	Power supply, 7.5V 30W	Consult

Tracer AV2

Base Assembly

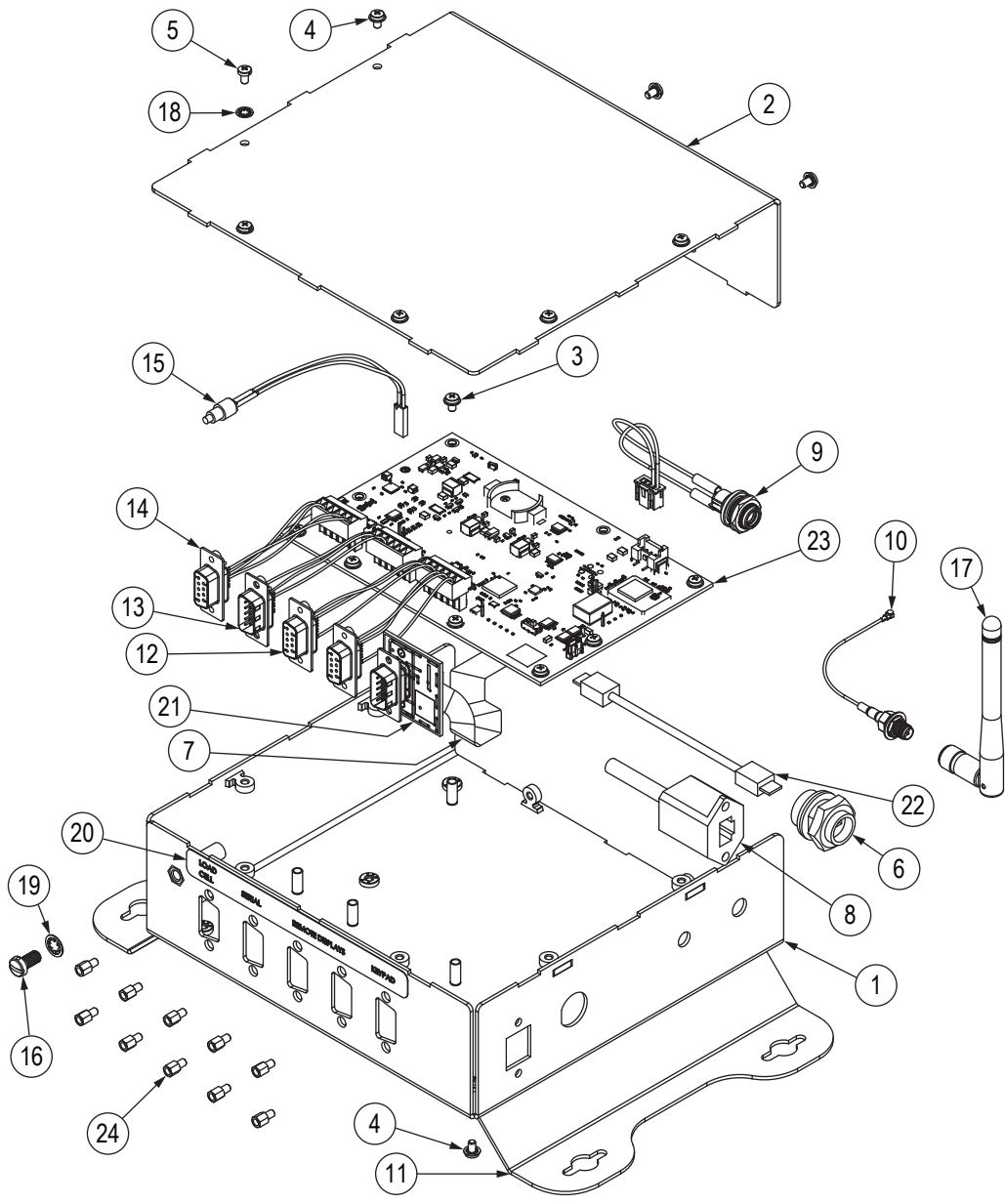

Aviation

