

Film Feeder, Rear

Part Number/Price

REF #	PART #	DESCRIPTION	QTY	SYNONYM	PRICE
1	Consult	Frame, feeder	1	000-135-2867-54	Consult
2	Consult	Rail, lower	1	000-135-2868-39	Consult
3	172543	Clamp assy, lower	1	000-135-2871-11	Consult
4	Consult	Bracket, harness	1	000-136-3629-09	Consult
5	Consult	Supporter, frame, feeder	1	000-146-5403-19	Consult
6	198374	Shaft, tension, feeder	2	000-130-6894-06	Consult
7	47165	Bearing, radial	4	000-000-3610-03	Consult
8	177258	Timing, pulley, T5, AF, tension	2	000-111-8468-18	Consult
9	171838	Timing white belt, DT5, P1.5	1	000-135-0175-06	Consult
10	185877	Flat, green belt, endless, beveled (blue mark), front or rear	1	100-019-0009-00	Consult
11	160748	Bearing, radial, deep groove	4	000-094-2649-05	Consult
12	Consult	Timing pulley, T5, AF	1	000-111-8465-08	Consult
13	Consult	Flange, pulley, upper	1	000-111-8467-05	Consult
14	Consult	Shaft, pulley, follower	1	000-130-6821-04	Consult
15	189229	Pin, parallel	2	000-040-6521-02	Consult
16	193535	Timing pulley, T5, AF	1	000-065-9537-07	Consult
17	Consult	Shaft, pulley, drive	1	000-147-7501-06	Consult
18	88644	Timing pulley, S5M, A	1	000-045-3708-07	Consult
19	189230	Key, parallel, both ends round	2	000-009-9828-05	Consult
20	175307	Gear, flat	1	000-090-0652-01	Consult
—	178070	M10 Ext. retaining ring	1	—	Consult
21	Consult	Holder, pulley	1	000-135-2696-44	Consult
22	172572	Bearing, radial, deep groove	2	000-094-2650-00	Consult
23	Consult	Shaft, follower, belt	1	000-130-6867-14	Consult
24	192430	Pulley, drive, round	1	000-079-1252-14	Consult
25	Consult	Gear, flat	1	000-076-1779-09	Consult
26	Consult	Bracket, sensor, film	1	000-135-2693-43	Consult
27	Consult	Cover, harness	1	000-139-9348-14	Consult
—	184890	Screw, M3-0.5 x 5mm, SST, machine, phillips pan head	1	000-004-9689-08	Consult
28	175366	Lever, film	1	000-139-9353-13	Consult
29	175367	Spring, plate, over sensor	1	000-139-9347-01	Consult
30	198678	Bush	2	000-030-2873-00	Consult
31	Consult	Bracket, film sensor	1	000-135-2699-46	Consult
32	175363	Lever, film	1	000-146-5491-09	Consult
33	175364	Spring plate, film sensor	1	000-112-6666-00	Consult
34	175365	Spring, coil	1	000-108-0198-51	Consult
35	Consult	Bracket, pulley, idler	2	000-136-3628-04	Consult
36	Consult	Shaft, pulley, idler	2	000-135-2745-15	Consult
37	192742	Pulley assy, idler	2	000-079-3487-01	Consult
38	Consult	Frame, pinch	1	100-006-9897-00	Consult
39	Consult	Cover, spring	1	000-136-3635-01	Consult
40	202718	Spring, coil, compressive	1	000-137-0943-22	Consult
41	202717	Plate B, pinch	1	000-136-3625-03	Consult
42	172544	Solenoid assy, pinch, L208	1	100-000-8505-00	Consult
43	189232	Bearing, radial	2	000-001-6607-00	Consult
44	202716	Bracket, pinch, inside	1	000-137-0923-20	Consult
—	185810	Guide, film belt, pinching rear	1	100-018-3937-00	Consult
45	202715	Pinch assy, rear	1	000-140-7154-16	Consult
46	193702	Collar, step	3	000-109-8190-12	Consult
47	171844	Lever assy, clamp, L205, L206, L207	3	000-138-5782-07	Consult
48	Consult	Shaft, clamp	1	000-135-2791-17	Consult
49	Consult	U plate B, clamp	3	000-136-3631-06	Consult
50	Consult	U plate B, clamp	1	000-136-3632-00	Consult
51	192218	Spring, coil, compressive	3	000-109-8185-13	Consult
52	167958	Plain, washer, M6 flat SST	3	000-055-4170-07	Consult
53	Consult	Collar, spacer	3	000-001-6812-07	Consult
54	189235	Block B, fulcrum, clamp	3	000-111-8436-00	Consult
55	189242	Block B, fulcrum, clamp	5	000-111-8435-06	Consult
56	204583	Lever clamp, rear, center	1	000-136-3660-05	Consult

Film Feeder, Rear

Part Number/Price

REF #	PART #	DESCRIPTION	QTY	SYNONYM	PRICE
57	202254	Lever, clamp, rear, left side	1	000-136-3653-09	Consult
58	202253	Lever, clamp rear, right side	1	000-136-3656-10	Consult
59	Consult	Cover, clamp	1	100-005-2662-00	Consult
60	172545	Solenoid assy, L210	1	100-004-5496-00	Consult
61	172318	Spring, coil, compressive	1	000-109-8110-14	Consult
63	Consult	Plate B, plunger, belt hold	1	100-001-6592-00	Consult
64	Consult	Guide, plunger	1	100-001-6591-00	Consult
65	Consult	Bracket, solenoid, belt hold	1	100-001-6590-00	Consult
66	Consult	Block B, belt hold	1	100-001-6589-00	Consult
67	Consult	Lever, belt, hold	1	100-001-6588-00	Consult
68	189243	Collar, spacer	1	100-007-0164-00	Consult
69	189245	Collar, spacer	1	100-007-0165-00	Consult
70	171849	Rail assy, clamp, rear, center	1	100-006-5425-00	Consult
71	171850	Rail assy, clamp, rear, left side	1	000-136-3742-06	Consult
72	171851	Rail assy, clamp, rear, right side	1	000-136-3743-00	Consult
—	193528	Screw, M3x6 Gizalite pan head tapping Phillips SST	3	000-137-0958-00	Consult
73	200512	Spring pin, M3x8 mm Black Oxide	1	000-000-2156-05	Consult
74	185812	Guide, belt	1	100-018-3940-00	Consult
—	185813	Tapping screw, washer head SST, M3x6	1	000-079-3018-07	Consult
501	104239	Photo interrupter, transmitter, film over, white conn., B207, B211	2	000-070-5204-14	Consult
502	171837	Photo interrupter, transmitter, film detect, straight connector, B210	1	000-132-6468-07	Consult
601	199454	Harness, C9, film feeder	1	100-001-2955-01	Consult
ASSY	179472	Film feeder assy, complete, rear	1	100-002-0180-00	Consult
ASSY	200563	Film feeder belt kit - includes two of each: 171838 and 185877 (Parts for front and rear film feeders)			Consult
ASSY	200561	Film clamp kit - includes two of: 172543 and one each of: 171846, 171847, 171848, 171849, 171850, 171851 (Parts for front and rear film feeders)			Consult

Ishida WM-AI

Ishida WM-Ai

Film Feeder, Rear

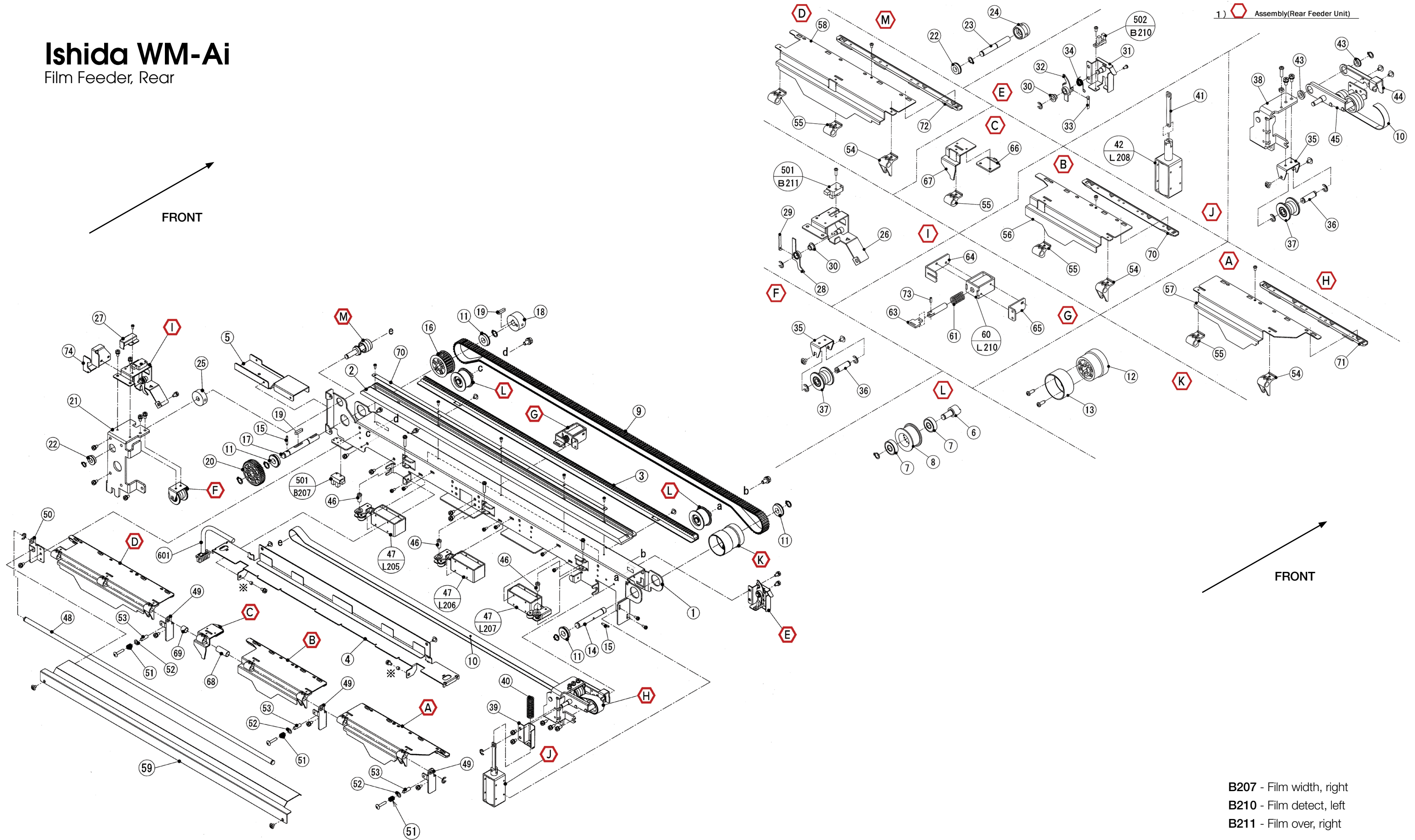

1) Assembly(Rear Feeder Unit)

B207 - Film width, right
 B210 - Film detect, left
 B211 - Film over, right