

# CW-90/90X Checkweigh Indicator

## Overlay Replacement

This document includes directions for the removal and replacement of a CW-90 or CW-90X indicator overlay.



Manuals and additional resources are available from Rice Lake Weighing Systems at [www.ricelake.com/manuals](http://www.ricelake.com/manuals)



**WARNING** Always disconnect power before opening an enclosure. Procedures requiring work inside the indicator must be performed by qualified service personnel only.



**CAUTION** A grounding wrist strap must be worn to protect components from electrostatic discharge (ESD) when working inside an enclosure.

### Overlay Removal

1. Disconnect power to the indicator.
2. Remove the enclosure backplate to gain access to the CPU board.
3. Carefully remove the CPU board and power supply, disconnecting the overlay ribbon cable and any other connections.



**Note** Letting the enclosure sit in a freezer helps with overlay removal, causing the adhesive to become stiff and glassy. Make sure to remove all electronics from the enclosure before placing it in a freezer.

4. Turn the indicator over, so the overlay is up, and brace/secure the enclosure for overlay removal.
5. Start at a corner of the overlay, using a putty knife or similar flat-blade tool to get underneath and remove the overlay.



**IMPORTANT** Make sure to apply controlled pressure at a low angle with the edge of the flat-blade tool to avoid damaging the enclosure. Never press towards self.

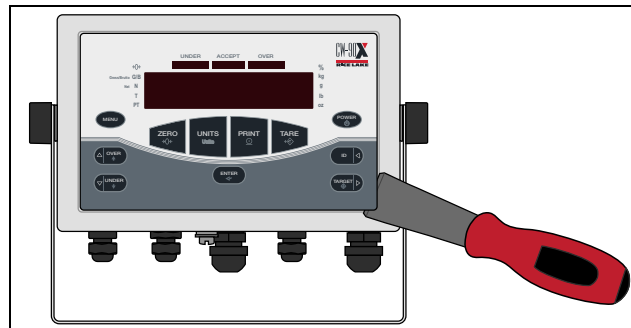

Figure 1. Overlay Removal



**Note** If the lower layer of the overlay remains on the enclosure, continue to use the flat-blade tool to remove all of the overlay until only adhesive residue is left. Inserting the flat-blade tool under the thin portion of the overlay lower layer, above the display window, can help in the removal of the lower layer of the overlay.

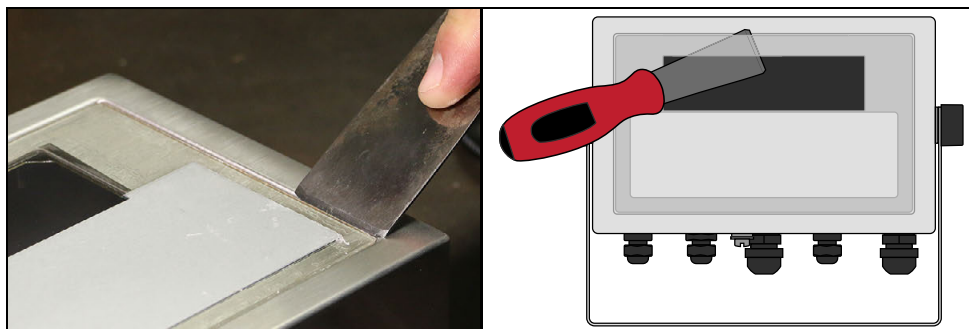

Figure 2. Overlay Lower Layer Removal

6. Apply an adhesive removal cleaner to the adhesive residue on the enclosure and let soak for 5-10 minutes. Proceed to the next step before the cleaner dries.



Figure 3. Adhesive Residue

7. Carefully rub adhesive residue from the enclosure.
8. Wipe excess adhesive and cleaner residue from the enclosure.
9. Repeat [Steps 6-8](#) until enclosure is free of all adhesive and cleaner residue.



Figure 4. Clean Enclosure

10. Clean enclosure using an alcohol wipe or alcohol cleaning solvent to make sure all residue has been removed.

**IMPORTANT**

*The overlay seal can be affected if the application surface is not properly cleaned.*

## Overlay Installation

1. Remove adhesive backing from the new overlay. The overlay should be kept as flat as possible during installation.

**IMPORTANT**

*Make sure surface is properly cleaned and free of any oil or debris before applying the new overlay. Do not apply the new overlay at temperatures below 50°F (10°C) to achieve a proper bond and seal.*

2. Insert ribbon cable into the enclosure, making sure it passes all the way into the enclosure, so the overlay adhesive can not make contact with it. If done incorrectly, this can affect the seal of the overlay.

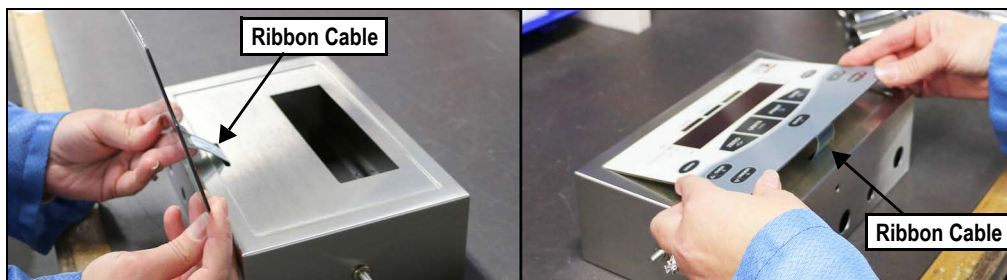

Figure 5. Overlay Ribbon Cable Insertion

- Carefully place overlay in the debossed area, making sure it is not contacting the raised edges of the overlay frame. Incorrect placement can create an air pocket that causes the overlay not to seal properly.

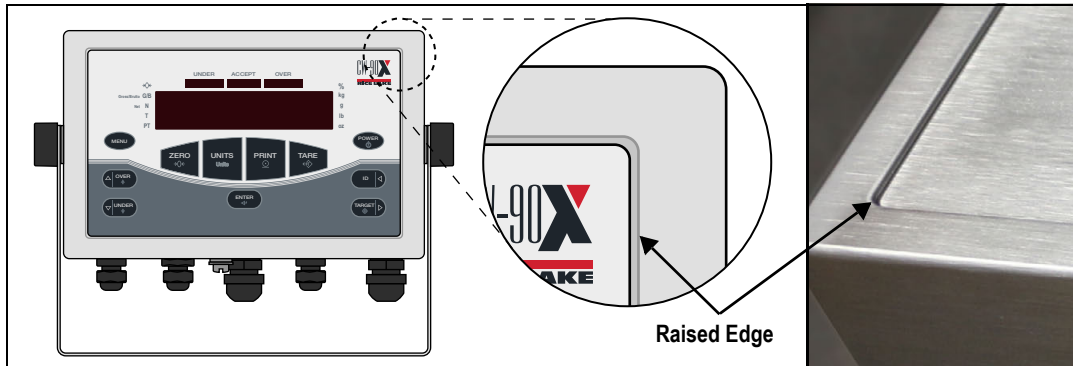

Figure 6. Overlay Frame Raised Edge

**IMPORTANT**

*The overlay uses a pressure activated adhesive and applying smooth, firm pressure throughout the overlay is critical to achieve a proper bond and seal.*

- Use an 80 shore A durometer rubber roller to apply smooth, firm pressure to the overlay for a minimum of 5 minutes. Start rolling from one side of the overlay to the other to decrease the chance of air bubbles forming.  
For CW-90 units: Use the rubber roller at a slight angle around the buttons to avoid applying direct pressure to them. Make sure to apply firm pressure to all non-button areas of the entire overlay.  
For CW-90X units: Use the rubber roller over the entire overlay and button locations.

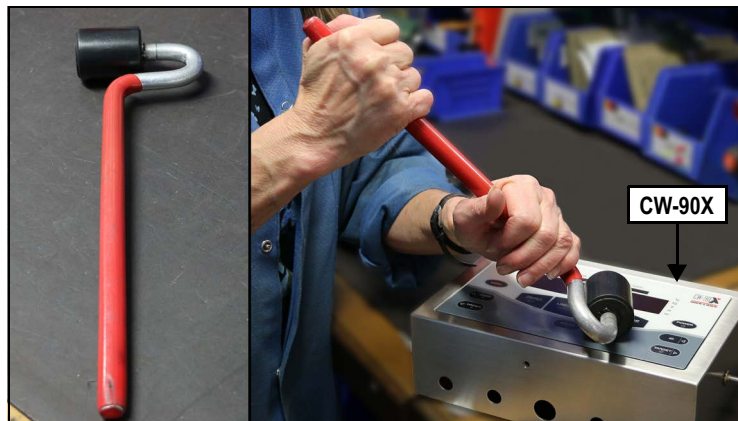

Figure 7. Rubber Roller for Overlay Application

- Carefully connect the overlay ribbon cable to the CPU board and reinstall the CPU board in the enclosure.
- Reconnect all necessary cable connections and secure the enclosure backplate to the enclosure.



**Note** See the *CW-90/90X Technical Manual (PN 105942)* for additional details on general installation and cable connections.



© Rice Lake Weighing Systems Specifications subject to change without notice.  
Rice Lake Weighing Systems is an ISO 9001 registered company.

230 W. Coleman St. • Rice Lake, WI 54868 • USA  
U.S. 800-472-6703 • Canada/Mexico 800-321-6703 • International 715-234-9171 • Europe +31 (0)26 472 1319