

Printer Unit - POP

Part Number/Price

REF #	PART #	DESCRIPTION	QTY	SYNONYM	PRICE
1	199806	Shaft, step	1	100-012-0773-00	Consult
2	157891	Roller, label, hold assy	6	000-079-8591-03	Consult
3	178216	Frame	1	100-011-0226-01	Consult
4	157916	Collar	4	000-091-8682-18	Consult
5	157917	Collar	7	000-077-4891-21	Consult
6	187432	Shaft, stock	1	000-136-3566-07	Consult
7	Consult	Bracket, sensor, peel R	1	000-116-1722-24	Consult
8	Consult	Bracket, sensor, peel L	1	000-116-1723-37	Consult
9	187433	Shaft, roller	2	000-044-3821-17	Consult
10	110525	Roller	1	000-060-8956-04	Consult
11	195783	Plate A, holder	1	000-136-3565-03	Consult
12	195782	Bracket, assist	2	000-078-0818-01	Consult
13	187438	Collar, spacer	4	000-059-4384-06	Consult
14	187439	Spring, coil, compressive	4	000-086-7397-10	Consult
15	Consult	Shaft, assist	1	000-136-3567-01	Consult
16	Consult	Bracket, assist, upper	1	100-012-2455-00	Consult
17	Consult	Spring, coil, twisted	1	100-008-3581-00	Consult
18	187446	Spring, coil, compressive	4	000-072-5278-14	Consult
19	187447	Roller, assist	1	000-069-4967-06	Consult
20	Consult	Shaft, label, back paper	1	100-007-9604-00	Consult
21	Consult	Guide, label	1	100-007-8412-00	Consult
22	Consult	Gear, flat	1	000-076-1780-03	Consult
23	172640	Motor assy stepping, M410	1	000-111-5669-19	Consult
24	Consult	Bracket, motor	1	100-009-1732-00	Consult
25	178217	Motor assy reel, M411	1	000-072-5467-22	Consult
26	153086	Gear, flat	1	000-047-0630-04	Consult
27	Consult	Bracket, motor, DC	1	100-009-1726-00	Consult
28	Consult	Bracket, press, label	1	000-116-1721-49	Consult
29	Consult	Bracket, PR roller, L	1	100-012-0496-00	Consult
30	187457	Timing pulley, S3M, C	2	000-073-7220-04	Consult
31	125887	Timing belt, CP-S3M	1	000-139-2517-02	Consult
32	178218	Platen, roller, print	2	000-116-1736-26	Consult
33	Consult	Frame, print	1	000-116-1716-31	Consult
34	178219	Shaft assy peeling	1	100-012-2633-00	Consult
35	187459	Shaft, idler	1	000-078-0831-10	Consult
36	Consult	Bracket, platen, R	1	000-116-1728-35	Consult
37	187460	Shaft, stock	1	000-070-9862-47	Consult
38	Consult	Gear, flat	1	000-112-6672-02	Consult
39	93355	Bush	4	000-064-0201-24	Consult
40	187462	Bush	1	000-075-1324-01	Consult
41	187463	Bush	1	000-075-1325-04	Consult
42	187477	Bush	1	000-075-1321-00	Consult
43	172643	Bearing, radial	2	000-065-6920-00	Consult
44	Consult	Frame, printer, POP	1	100-011-0477-01	Consult
45	178220	Winding unit assy	1	100-011-7204-00	Consult
46	Consult	Spring, coil, compressive	1	000-116-1745-11	Consult
47	Consult	Hinge	1	000-013-9941-09	Consult
—	Consult	Screw, counter sink, M3x8	6	—	Consult
48	Consult	Bracket assy printer	1	100-009-1602-00	Consult
49	Consult	Bracket, printer, thermal	1	000-116-1730-24	Consult
50	187464	L plate A, spring, support	1	000-078-0994-04	Consult
51	187465	Stay, head, thermal	1	000-078-0993-29	Consult
52	187466	Plate B, press, head	1	000-078-0992-16	Consult
53	Consult	Bracket, sensor, head up	1	000-116-1733-34	Consult
54	Consult	Frame, printer, platform	1	100-010-7129-01	Consult
55	198653	Bracket, label, sensor	1	100-011-1527-01	Consult
56	198654	Cover, label, sensor	1	100-009-1724-00	Consult

Printer Unit - POP

Part Number/Price

REF #	PART #	DESCRIPTION	QTY	SYNONYM	PRICE
57	Consult	Cover, head	1	000-116-1739-45	Consult
58	Consult	Catch, magnet	1	000-088-8332-07	Consult
59	Consult	Gasket	1	000-065-1825-01	Consult
60	172667	Spring, coil, compressive	3	000-072-8616-01	Consult
61	187470	Screw, cross pan head, M1.7x6 mm SST	2	000-090-5431-02	Consult
62	187471	Plain washer, M1.7 SST	2	000-090-5432-06	Consult
63	187472	Spring washer, M1.7 SST	2	000-090-5433-00	Consult
64	187473	Collar B	2	000-079-8972-09	Consult
65	187474	Block A, assist	1	000-091-8679-07	Consult
66	187476	Collar, spacer	4	000-113-7378-08	Consult
67	Consult	Lever, assist, under	1	100-009-1092-01	Consult
68	Consult	Bracket, assist, under	1	100-009-1091-00	Consult
69	Consult	Shaft, lever, assist	1	000-116-1719-13	Consult
70	Consult	Spring, plate, lever	1	000-091-2449-14	Consult
71	Consult	Shaft, step, assist	1	000-116-1724-21	Consult
72	Consult	Collar, spacer	1	000-117-3065-16	Consult
73	Consult	Catch, magnet	2	100-011-1469-00	Consult
74	178221	Catch, magnet	1	000-027-2865-01	Consult
75	Consult	Stay, USB	1	000-144-5931-05	Consult
76	Consult	Bracket, power supply SW	1	100-012-0024-00	Consult
77	Consult	Guide, shaft	1	100-009-1802-00	Consult
78	187475	Collar A	2	000-095-9235-00	Consult
79	187450	Collar, step	1	000-076-7629-05	Consult
80	Consult	Guide, label	1	100-010-6526-00	Consult
81	178189	Shaft, label, spacer	1	100-008-8473-00	Consult
82	Consult	Plate A, fulcrum, holder	1	100-011-0588-00	Consult
83	Consult	Roller, paper core	1	100-011-0573-00	Consult
84	Consult	Holder, paper core	1	100-011-0579-01	Consult
85	Consult	Spring, plate, paper core	1	100-011-0580-01	Consult
86	Consult	Guide, label, POP	1	100-009-7029-01	Consult
87	Consult	Bracket, guide roller	1	100-010-9519-01	Consult
88	Consult	Roller, turn, label	2	100-009-7026-01	Consult
89	Consult	Spacer, turn, roller	1	100-010-9517-00	Consult
90	Consult	Roller, guide	1	100-010-9518-00	Consult
91	189208	Bush	2	000-076-1844-08	Consult
92	178222	Shaft, step, short	1	100-011-0227-01	Consult
93	178223	Torque limiter	1	000-078-0990-00	Consult
94	Consult	Shaft, fulcrum, holder	1	100-011-0587-00	Consult
95	Consult	Plate A, sensor	1	100-011-0483-00	Consult
96	Consult	Cover, sensor, open/close	1	100-011-0479-01	Consult
97	181386	Hinge, L	2	000-011-5730-01	Consult
98	Consult	Cover, printer	1	100-011-1555-01	Consult
99	198655	Cover, label, sensor	1	100-011-2014-01	Consult
100	178190	Roller, label	1	100-012-1219-00	Consult
101	178225	C-ring for shaft	1	000-014-8693-09	Consult
501	178226	PWB P-1131A-3, pop printer board, A410	1	100-009-2885-01	Consult
502	171875	Print head, thermal, E400	1	100-010-2669-00	Consult
503	105979	Magnet, green, for proximity switch, head up (B415), printer door (B420)	2	000-067-2609-01	Consult
—	189088	Screw, mount, Cross-Head, M2x4, SST	4	—	Consult
504	171876	Photo interruptor, peel sensor, trans, B410	1	000-112-1169-16	Consult
505	171877	Photo interruptor, peel sensor, rec, B411	1	000-112-1170-11	Consult
506	125717	Switch, rotary, main power on/off, S100	1	000-134-8366-02	Consult
601	178227	Sensor assy POP, label gap/head up, B412, B413	1	100-005-2664-00	Consult
602	Consult	Harness, C2, USB (A10 XJ4 to A410 XJ7)	1	100-006-5608-00	Consult
603	178228	Harness, S2, thermal head (A410 XJ22 to E400 print head)	1	100-007-8314-00	Consult
604	Consult	Harness, C4, motor (A410 XJ16 to M401 and A410 XJ11 to M411)	1	100-007-8312-00	Consult

Printer Unit - POP

Part Number/Price

REF #	PART #	DESCRIPTION	QTY	SYNONYM	PRICE
605	182821	Harness, C2, to B414 (peel sensor receiver) (B411 to conn B411 [X411])	1	100-002-3521-00	Consult
606	189288	Harness, C5, power supply SW (S100 to X109)	1	000-137-8216-27	Consult
607	178229	Sensor assy, printer door open/closed, B419	1	100-006-3340-00	Consult
—	189088	Screw, mount, Cross-Head, M2x4, SST	2	—	Consult
ASSY	200439	Stand by roller unit assy, pop		100-019-4166-00	Consult
ASSY	200440	Roller, stand by, short, assy, pop (includes 2, 4, 92, 100, and 101)		100-020-2565-00	Consult

Ishida WM-Ai

Printer Unit - POP

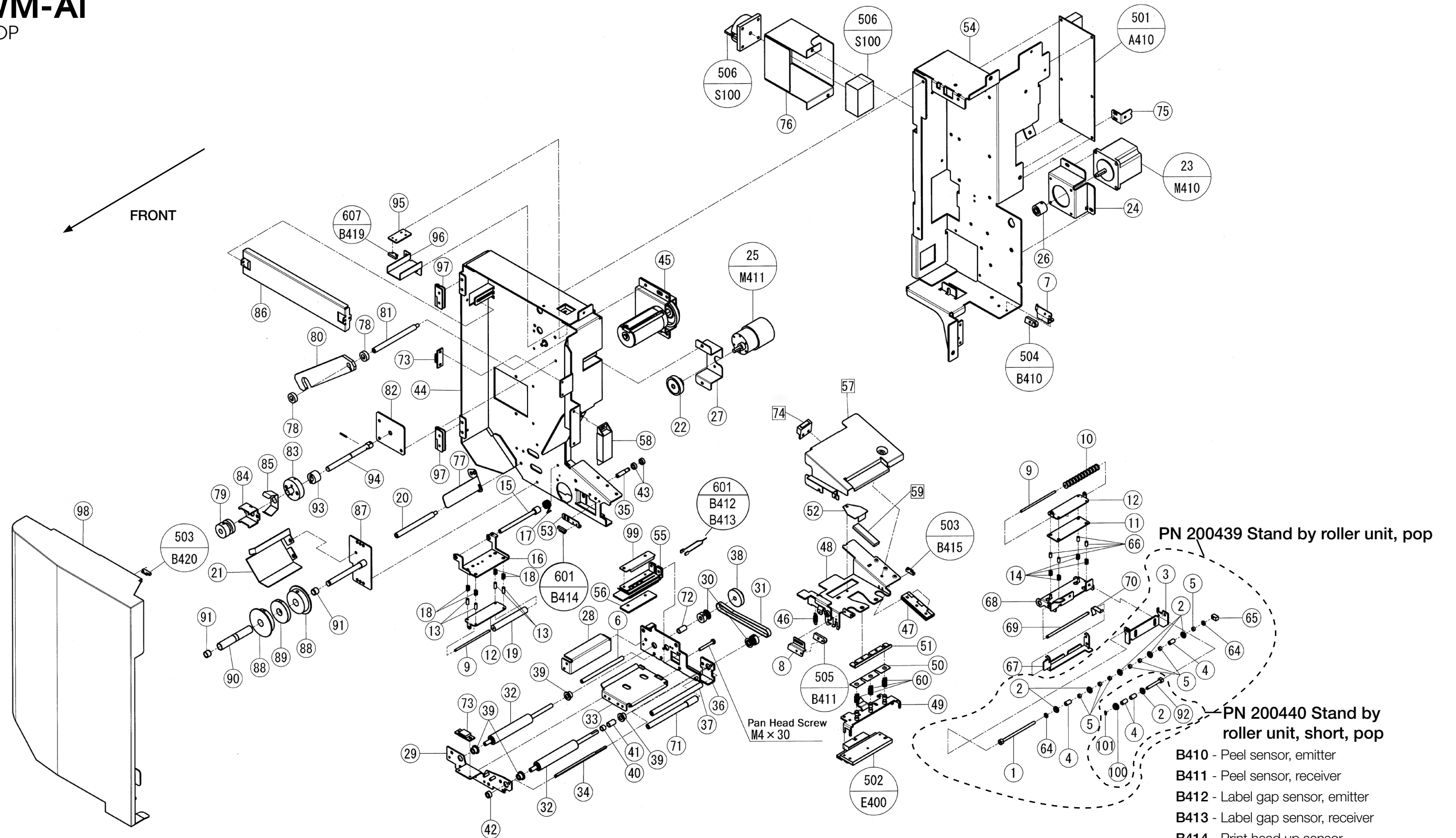

- B410 - Peel sensor, emitter
- B411 - Peel sensor, receiver
- B412 - Label gap sensor, emitter
- B413 - Label gap sensor, receiver
- B414 - Print head up sensor
- B415 - Print head up magnet
- B419 - Printer cover open/closed sensor
- B420 - Printer cover open/closed magnet