

# RL20000 SS S-Beam, Stainless Steel

## NTEP 1:10000 Class III Single Cell, IP67

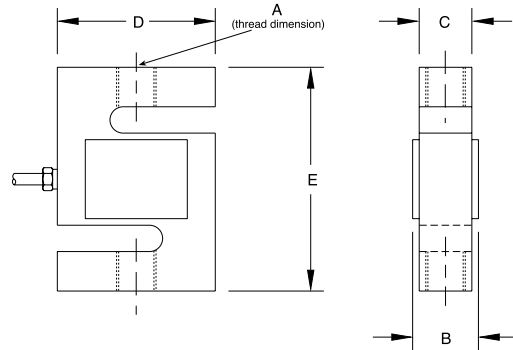

Picture is a representation of actual product



RATED CAPACITY	DIMENSIONS				
	A	B	C	D	E
<b>lb/inches</b>					
50-250	1/4-28 UNF-2B	.65	.46	2.00	2.40
500-1000	1/2-20 UNF-2B	.90	.71	2.00	2.40
2500	1/2-20 UNF-2B	1.15	.96	2.00	2.40
3000	1/2-20 UNF-2B	1.15	.96	3.00	3.90
5000	3/4-16 UNF-2B	1.15	.96	3.00	3.90
10,000	3/4-16 UNF-2B	1.15	.96	3.00	3.90
<b>kg/mm</b>					
22.7-113.4	1/4-28 UNF-2B	16.5	11.7	50.8	61.0
226.8-453.6	1/2-20 UNF-2B	22.9	18.0	50.8	61.0
1134.0	1/2-20 UNF-2B	29.2	24.4	50.8	61.0
1360.8	1/2-20 UNF-2B	29.2	24.4	76.2	86.1
2268.0	3/4-16 UNF-2B	29.2	24.4	76.2	86.1
4535.9	3/4-16 UNF-2B	29.2	24.4	76.2	99.1

### SPECIFICATIONS:

<b>Full Scale Output:</b>	3.0 mV/V (+/- .008)	<b>Hysteresis:</b>	0.02% Full scale
<b>Bridge Resistance:</b>	350 ohms, nominal	<b>Insulation Resistance:</b>	5000 megohms
<b>Material/Finish:</b>	Stainless steel	<b>Cable Length:</b>	20'/6.1 m
<b>Temperature:</b>	Compensated range 14°F to 104°F/-10°C to 40°C	<b>Cable Color Code:</b>	Red ..... + Excitation Black..... - Excitation Green..... + Signal White ..... - Signal
<b>Seal Type:</b>	Environmentally-sealed, IP67	<b>Warranty:</b>	Two-year limited warranty
<b>Safe Overload:</b>	150% Full scale		
<b>Rated Excitation:</b>	10V DC (15V maximum)		
<b>Nonlinearity:</b>	0.03% Full scale		

### RL20000 SS ORDER INFORMATION

Load Rating	Part #	Price
<b>RL20000SS NTEP</b>		
100 lb (45.4 kg)	46511	\$295.00
250 lb (113.4 kg)	46503	\$295.00
500 lb (226.8 kg)	46504	\$295.00
750 lb (340.2 kg)	46505	\$295.00
1000 lb (453.6 kg)	46506	\$295.00
2500 lb (1134.0 kg)	46507	\$295.00
3000 lb (1360.8 kg)	46508	\$395.00
5000 lb (2268.0 kg)	46509	\$495.00
10,000 lb (4535.9 kg)	46510	\$495.00

### RL20000SS NON-NTEP

50 lb (22.9 kg) ..... 17013.....\$295.00

**Conduit Adapter Kit\* (must be factory installed to maintain warranty)**

3/8-24 Nipple	31533*	\$27.00
3/8-24 to 1/4-18 NPT	31534*	\$27.00

\* Parts #31533 and #31534 must be installed together to form the Conduit Adapter Kit

### INTERCHANGEABLE PRODUCTS

Manufacturer	Model
Vishay Revere Transducers.....	(see page 265) 9363
Artech .....	SS20210

### WEIGH MODULE AVAILABLE

Model	Page #
ITCM Isolated Tension Cell Mount.....	357