

RL20001 S-Beam, Alloy Steel

NTEP III L Single Cell, IP67

1:5000 III/1:10,000 IIIL



Picture is a representation of actual product

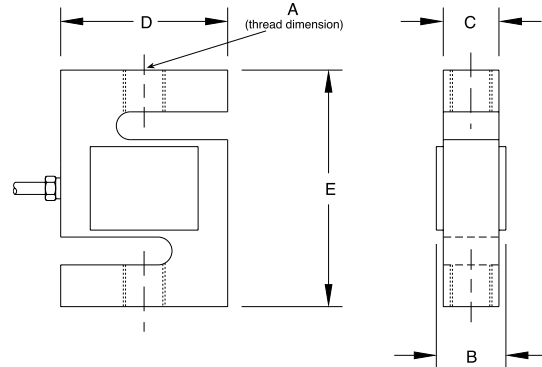

RATED CAPACITY	DIMENSIONS				
	A	B	C	D	E
lb/inches					
250	3/8-24 UNF-2B	.75	.50	2.00	3.00
500-2000	1/2-20 UNF-2B	1.00	.75	2.00	3.00
2500-3000	1/2-20 UNF-2B	1.25	1.00	2.00	3.00
5000	3/4-16 UNF-2B	1.25	1.00	3.00	4.25
10,000	3/4-16 UNF-2B	1.25	1.00	3.50	4.75
15,000	1-14 UNS-2B	1.50	1.25	4.00	5.50
20,000	1 1/4-12 UNF-2B	2.25	2.00	5.00	7.00
kg/mm					
113.4	3/8-24 UNF-2B	19.1	12.7	50.8	76.2
226.8-907.2	1/2-20 UNF-2B	25.4	19.1	50.8	76.2
1134.0-1360.8	1/2-20 UNF-2B	31.8	25.4	50.8	76.2
2268.0	3/4-16 UNF-2B	31.8	25.4	76.2	108.8
4535.9	3/4-16 UNF-2B	31.8	25.4	88.9	120.7
6803.9	1-14 UNS-2B	38.1	31.8	101.6	139.7
9071.9	1 1/4-12 UNF-2B	57.2	50.8	127.0	177.8

SPECIFICATIONS:

Full Scale Output: 3.0 mV/V
 Bridge Resistance: 350 ohms, nominal
 Material/Finish: High-alloy steel, nickel plated
 Temperature: Compensated range 14°F to 104°F/-10°C to 40°C
 Seal Type: Environmentally-sealed, IP67
 Safe Overload: 150% Full scale
 Rated Excitation: 10V AC/DC (15V max.)
 Nonlinearity: 0.03% Full scale

Hysteresis: 0.02% Full scale
 Insulation Resistance: 5000 megohms
 Cable Length: 20'/6.1 m
 Cable Color Code: Red + Excitation
 Black..... - Excitation
 Green..... + Signal
 White - Signal
 Warranty: Two-year limited warranty

RL20001 ORDER INFORMATION

Load Rating	Part #	Price
250 lb (113.4 kg)	21402	\$275.00
500 lb (226.8 kg)	21403	\$275.00
750 lb (340.2 kg)	21404	\$275.00
1000 lb (453.6 kg)	21405	\$275.00
1500 lb (680.4 kg)	21406	\$275.00
2000 lb (907.2 kg)	21407	\$275.00
2500 lb (1134.0 kg)	21408	\$275.00
3000 lb (1360.8 kg)	21409	\$315.00
5000 lb (2268.0 kg)	21410	\$440.00
10,000 lb (4535.9 kg)	21411	\$440.00
15,000 lb (6803.9 kg)	21412	\$555.00
20,000 lb (9071.9 kg)	21413	\$875.00

Conduit Adapter Kit* (must be factory installed to maintain warranty)
 3/8-24 Nipple31533*\$27.00
 3/8-24 to 1/4-18 NPT31534*\$27.00

*Parts #31533 and #31534 must be installed together to form the Conduit Adapter Kit

INTERCHANGEABLE PRODUCTS

Manufacturer	Model
Vishay Celtron	(see page 183) STC
Vishay Sensortronics	(see page 296) 60001

WEIGH MODULE AVAILABLE

Model	Page #
ITCM Isolated Tension Cell Mount	357