

# RLBLC Single-Ended Beam, Stainless Steel with Counter Bore

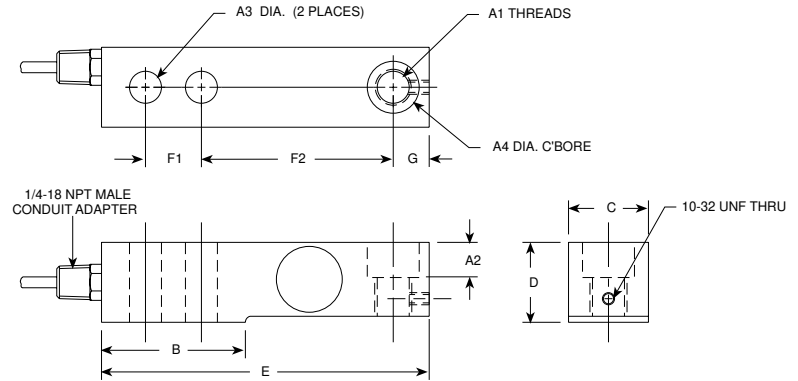

Picture is a representation of actual product



| RATED CAPACITY   | DIMENSIONS    |      |      |      |      |      |      |       |      |      |      |  |
|------------------|---------------|------|------|------|------|------|------|-------|------|------|------|--|
|                  | A1            | A2   | A3   | A4   | B    | C    | D    | E     | F1   | F2   | G    |  |
| <b>lb/inches</b> |               |      |      |      |      |      |      |       |      |      |      |  |
| 1000-4000        | 1/2-20 UNF-2B | .56  | .53  | .81  | 2.25 | 1.21 | 1.19 | 5.25  | 1.00 | 3.00 | .60  |  |
| 5000             | 3/4-16 UNF-2B | .79  | .78  | 1.19 | 3.00 | 1.45 | 1.44 | 6.75  | 1.50 | 3.75 | .75  |  |
| 10,000           | 3/4-16 UNF-2B | .79  | .78  | 1.19 | 3.00 | 1.69 | 1.69 | 6.75  | 1.50 | 3.75 | .75  |  |
| <b>kg/mm</b>     |               |      |      |      |      |      |      |       |      |      |      |  |
| 453.6-1814.4     | 1/2-20 UNF-2B | 14.2 | 13.5 | 20.6 | 57.2 | 30.2 | 30.2 | 130.1 | 25.4 | 76.2 | 12.7 |  |
| 2268.0           | 3/4-16 UNF-2B | 17.0 | 19.8 | 30.2 | 76.2 | 36.6 | 36.6 | 171.5 | 38.1 | 95.3 | 19.1 |  |
| 4535.9           | 3/4-16 UNF-2B | 20.1 | 19.8 | 30.2 | 76.2 | 36.6 | 49.3 | 171.5 | 38.1 | 95.3 | 19.1 |  |

## SPECIFICATIONS:

**Full Scale Output:** 3.0 mV/V nominal  
**Bridge Resistance:** 1000 ohms, nominal  
**Material/Finish:** Stainless steel  
**Temperature:** Compensated range  
 15°F to 115°F/-9°C to 46°C  
**Seal Type:** Environmentally-sealed  
**Safe Overload:** 150% Full scale  
**Rated Excitation:** 10V DC (15V maximum)  
**Nonlinearity:** 0.03% Full scale

**Hysteresis:** 0.05% Full scale  
**Insulation Resistance:** 5000 megohms  
**Deflection at Capacity:** 1000-4000 lb = .010"/.25 mm,  
 5000-10,000 lb = .012"/.30 mm  
**Cable Length:** 1000-4000 lb = 10'/3.1 m  
 5000-10,000 lb = 20'/6.1 m  
**Cable Color Code:** Green ..... + Excitation  
 Black..... - Excitation  
 White ..... + Signal  
 Red ..... - Signal  
**Warranty:** Two-year limited warranty

## RLBLC ORDER INFORMATION

| Load Rating   | Part # | Price    |
|---|--------|----------|
| 1,000 lb (453.6 kg)                                 | 17091  | \$275.00 |
| 2,500 lb (1134.0 kg)                                | 17096  | \$275.00 |
| 4,000 lb (1814.4 kg)                                | 17101  | \$275.00 |
| 5,000 lb (2268.0 kg)                                | 17104  | \$365.00 |
| 10,000 lb (4535.9 kg)                               | 17108  | \$465.00 |
| <b>Bushing (for conversion to non-counter base)</b> |        |          |
| 1000 lb - 4000 lb, SST                              | 17691  | \$8.00   |

## INTERCHANGEABLE PRODUCTS

| Manufacturer | Model              |
|--------------|--------------------|
| HBM          | (see page 235) BLC |