

Dimensioning

TABLE OF CONTENTS

Weigh-n-Dimension Systems..... 332
iDimension Plus and BenchPro Shipping Scale Package

iDimension® Plus / Plus XL..... 333
Static Dimensioning System

iDimension® Plus Mobile Cart 337

iDimension® Flex Series..... 338
Parcel and Pallet Static Dimensioning System

iDimension® PWD System..... 340
Pallet Weighing and Dimensioning System

iDimension® LTL / LTL XL 342
Pallet Dimensioning System

iDimension® SS..... 345
Integration Software

Product names, logos, brands and other trademarks featured or referred to within this publication are the property of their respective trademark holders.

Weigh-n-Dimension Systems

iDimension Plus and BenchPro Shipping Scale Package

DIMENSIONING



NEW

Packages

- Package 1 includes: iDimension Plus 1.5 m pole assembly, Rice Lake BenchPro shipping scale (150 lb)
- Package 2 includes: iDimension Plus 4K 1.5 m pole assembly, Rice Lake BenchPro shipping scale (150 lb)
- Package 3 includes: iDimension Plus 1.5 m pole assembly, Rice Lake BenchPro shipping scale (150 lb), kit for connection to shipping software, barcode scanner with four- port USB hub and computer cables
- Package 4 includes: iDimension Plus 4K 1.5 m pole assembly, Rice Lake BenchPro shipping scale (150 lb), kit for connection to shipping software, barcode scanner with four- port USB hub and computer cables

iDimension Plus Standard Features

- Easy to assemble in 30 minutes or less
- Displays dimensions in 0.2 seconds
- No special package placement requirements
- Includes touch screen monitor
- Capable to dimension opaque packaging
- Measurement capabilities beyond Legal for Trade limits
- Color camera included
- High resolution color image, 2880 x 2160 pixels, available from iDimension Plus 4 K
- iDimension Desktop Wedge program available as free download from www.ricelake.com

Approvals



Measurement Capabilities

Model	1.5 m	
Platform Distance	60 in (1,500 mm)	
Min/Max	Min	Max
Length	1.2 in (30 mm)	48 in (1,200 mm)
Width	1.2 in (30 mm)	32 in (800 mm)
Height	0 in (0 mm)	28 in (700 mm)
Division	0.2 in (5 mm)	

Legal for Trade approved minimum and maximum measurements are available from the country specific certificate of approval.

Part Numbers/Price

Part #	Description	Price
221294	iDimension Plus 1.5 m pole assembly with BenchPro shipping scale 150 lb (Package 1)	\$7,970.00
221295	iDimension Plus 4K 1.5 m pole assembly with BenchPro shipping scale 150 lb (Package 2)	\$9,570.00
221296	iDimension Plus 1.5 m pole assembly with BenchPro shipping scale 150 lb with Quick Scan barcode scanner, four-port USB hub and necessary cables (Package 3)	\$8,675.00
221297	iDimension Plus 4K 1.5 m pole assembly with BenchPro shipping scale 150 lb with Quick Scan barcode scanner, four-port USB hub and necessary cables (Package 4)	\$10,275.00

Options/Accessories

Part #	Description	Price
202027	Optional Factory Support: Up to 2 hours iDimension Plus remote support, includes initial configuration and scale setup, iDimension Desktop Wedge installation and operator training	\$250.00
Consult	Optional Extended Warranty - two-year standard iDimension Plus additional one-year extended warranty	\$750.00

BenchPro Standard Features

- Large six-digit backlight LCD display with 1-inch characters protected by heavy-duty tempered glass
- USB HID interface
- Powered through USB interface with dimensioner

iDimension Plus Specifications

Power Requirements:

110 to 240 V US power cord (included)

Communication Ports:

- (1) USB A
- (1) 10/100/1000 Base-T Ethernet

Display:

7 in (178 mm) touchscreen

Software Integration:

Simple API network integration through HTTP requests, status checking and XML parsing

Temperature Range:

32 °F to 104 °F (0 °C to 40 °C)

Integration Tools:

Rest API
iDim Desktop Wedge with SDK (software developers kit)

Approvals:

NTEP 19-040A2
OIML R129/2000-A-NL1-20.05
NMI Certified
MID Certified
CE Marked

Warranty:

Two-year limited

BenchPro Specifications

Weigh Platter:

12 × 14 inch
150 × 0.05 lb / 75 × 0.02kg capacity

Battery Power:

Four AA alkaline batteries, 6 V, with low battery indication at 4. V

Battery Life:

50 to 250 hrs depending on backlight and auto-shutdown settings

Annunciators:

Six: zero, gross/brutto, net, W1/W2/W3 multi-range

Display:

Large six-digit backlight LCD display with 1-inch characters protected by heavy-duty tempered glass

Communication Port:

USB HID interface 2.0 full speed

Integration Tools:

Rest API
iDim Desktop Wedge with SDK (software developers kit)

Approvals:

NTEP 17-002
Measurement Canada AM-6050
CE Marked

iDimension® Plus / Plus XL

Static Dimensioning System

DIMENSIONING



iDimension Plus XL

iDimension Plus (1.5m)

Approvals



Measurement Capabilities Based on Pole Assembly Height

Model	1.2 m		1.5 m		2 m XL	
Platform Distance	48 in (1,200 mm)		60 in (1,500 mm)		80 in (2,000 mm)	
Min/Max	Min	Max	Min	Max	Min	Max
Length	1.2 in (30 mm)	40 in (1,000 mm)	1.2 in (30 mm)	48 in (1,200 mm)	8 in (203 mm)	48 in (1,200 mm)
Width	1.2 in (30 mm)	24 in (600 mm)	1.2 in (30 mm)	32 in (800 mm)	8 in (203 mm)	32 in (800 mm)
Height	0 in (0 mm)	24 in (600 mm)	0 in (0 mm)	28 in (700 mm)	4 in (102 mm)	32 in (800 mm)
Division	0.2 in (5 mm)		0.2 in (5 mm)		0.5 in (10 mm)	

Legal for Trade approved minimum and maximum measurements are available from the country specific certificate of approval.

Part Numbers/Price

Part #	Description	Price
Parcels less than 40 inches (1.2m pole)		
204599	iDimension Plus 1.2m pole assembly	\$7,245.00
204600	iDimension Plus 4K 1.2m pole assembly	\$8,845.00
Parcels less than 48 inches (1.5m pole)		
204596	iDimension Plus 1.5m pole assembly	\$7,245.00
204598	iDimension Plus 4K 1.5m pole assembly	\$8,845.00
iDimension Plus XL		
204601	iDimension Plus XL	\$5,295.00
204602	iDimension Plus XL 4K	\$7,345.00
iDimension Plus XL Mounting Options		
174660	iDimension XL floor stand	\$1,400.00
198708	iDimension XL mounting hardware and cable assembly kit with 25 ft North American power cord	\$175.00
206583	iDimension XL mounting hardware and cable assembly kit without power cord	\$175.00
184262	iDimension USB operator display RAM® mount kit	\$145.00

Standard Features

- iDim Plus package includes: Base plate, pole assembly, USB display, calibration object, US power cord, operating manual and assembly tool kit
- iDim Plus XL package includes: iDimension Plus XL scanner head, 10 ft Ethernet cable, USB display, calibration object, US power cord and operating manual
- Easy to assemble in 30 minutes or less
- Displays dimensions in 0.2 seconds
- No special package placement requirements
- Capable to dimension opaque packaging
- Measurement capabilities beyond Legal for Trade limits
- Standard resolution color camera
- High resolution color image, 2880 × 2160 pixels, available from iDimension Plus 4K

Options

- iDimension SS (Software Suite) or iDimension Desktop Wedge programs for data integration
- Powered USB hub for use of more than one peripheral
- Wired or wireless USB bar code scanner
- Rice Lake BenchPro shipping/postal scales
- Rice Lake 680, 880, 1280 indicators available for automation applications

Specifications

Power Requirements:

110 to 240 VAC
US power cord (included)

Communication Ports:

(1) USB A
(1) 10/100/1000 Base-T Ethernet

Display:

7 in (178 mm) touchscreen monitor

Accuracy:

Certified Legal for Trade at 0.2 in (5 mm) cuboidal shapes
Certified Legal for Trade at 0.5 in (10 mm) irregular shapes

Software Integration:

Simple API network integration through HTTP requests, status checking and XML parsing

Temperature Range:

Certified: 32 °F to 104 °F (0 °C to 40 °C)

Humidity:

Non-condensing

Warranty:

Two-year limited

Approvals:

NTEP 19-040
OIML T11908
CE
EU Mid
FCC
NMI

iDimension® Plus / Plus XL

Static Dimensioning System

DIMENSIONING

Options/Accessories

Part #	Description	Price
Accessories		
180007	Kit, USB Hub, 5 m cable assembly, power adapter, four-port industrial USB hub, US power supply	\$280.00
180771	Kit, USB Hub for shipping software integration, Includes four-port USB hub, power adapter USB to serial cables. Barcode scanner not included	\$430.00
205533	Power cord, detachable, German/French, 5 m, CEE 7/7, Type E plug	\$45.00
95589	Power cord, detachable, UK, 2.5m, BS1363 Type G plug	\$21.00
162630	Power cord, detachable, AU / NZ, 2.5m, 1332 Type 1 plug	\$35.00
178501	RS-232/USB cable, for use with compatible indicators	\$60.00
Barcode Scanner		
176307	QuickScan QD2131 USB barcode scanner	\$305.00
206225	Wireless Honeywell 1981IFR-3USB-5-N long-range barcode scanner	\$1,800.00
Optional Integration Solutions		
180771	Shipping software integration kit includes four-port industrial USB hub, power adapter and USB cables to connect computer and dimensioner	\$430.00
203010	iDimension Desktop Wedge requires Windows 10 or newer (Available for free download at www.ricelake.com)	N/C
175812	iDimension SS (software suite) web server software requires Windows 10 or newer	\$2,250.00
Optional Factory Service and Support		
202027	Up to 2 hours iDim Plus remote support, includes initial configuration and scale setup, iDimension Desktop Wedge installation and operator training.	\$250.00/Unit
Extended Warranty – Two-year standard		
202030	iDimension Plus one-year optional extended warranty	\$750.00

Rice Lake BenchPro Compatible Scales

Postal Scale 12 × 14 in (305 × 356 mm) Weigh Platter

194625 *	Model BP 1214-35P - 70 lb postal scale, painted mild steel weight platter	\$725.00
----------	---	----------

Shipping Scale 12 × 14 in (305 × 356 mm) Weigh Platter

184585	Model BP 1214-75S, 150 × 0.05 lb / 75 × 0.02 kg painted mild steel weigh platter	\$725.00
--------	--	----------

Shipping Scale 18 × 18 in (457 × 457 mm) Weigh Platter

202191	Model BP 1818-75S, 150 × 0.05 lb / 75 × 0.02 kg, painted mild steel weigh platter	\$1,590.00
201730	Model BP 1818-75S, 150 × 0.05 lb / 75 × 0.02 kg ball top weigh platter	\$1,835.00
202190	Model BP 1818-75S, 150 × 0.05 lb / 75 × 0.02 kg roller conveyor weigh platter	\$1,650.00

Shipping Scale 20 × 20 in (508 × 508 mm) Weigh Platter

182396	Model BP 2020-150S, 300 × 0.1 lb / 150 × 0.05 kg, painted mild steel weigh platter	\$1,805.00
182397	Model BP 2020-150S, 300 × 0.1 lb / 150 × 0.05 kg, ball top weigh platter	\$2,035.00
182398	Model BP 2020-150S, 300 × 0.1 lb / 150 × 0.05 kg, roller conveyor weigh platter	\$1,769.00

Shipping Scale 24 × 24 in (610 × 610 mm) Weigh Platter

182400	Model BP 2424-150S, 300 × 0.1 lb / 150 × 0.05 kg, painted mild steel weigh platter	\$2,005.00
182401	Model BP 2424-150S, 300 × 0.1 lb / 150 × 0.05 kg, ball top weigh platter	\$2,240.00
182402	Model BP 2424-150S, 300 × 0.1 lb / 150 × 0.05 kg, roller conveyor weigh platter	\$1,939.00

*USB HID interface not available when in the postal scale lb/oz mode



Model BP 1214-S with mild steel weigh platter

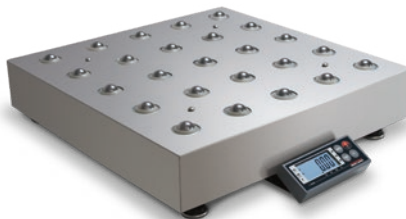

Model BP 1818-S with ball top weigh platter



Model BP 2424-S with roller conveyor weight platter

Dimensions

iDimension Plus, 1.5m			
A	63.20 in (1,605 mm)	F	19.40 in (493 mm)
B	60.20 in (1,529 mm)	G	2.80 in (71 mm)
C	36.10 in (917 mm)	H	14.30 in (363 mm)
D	4.00 in (102 mm)	I	19.40 in (493 mm)
E	1.80 in (46 mm)	J	25.00 in (635 mm)

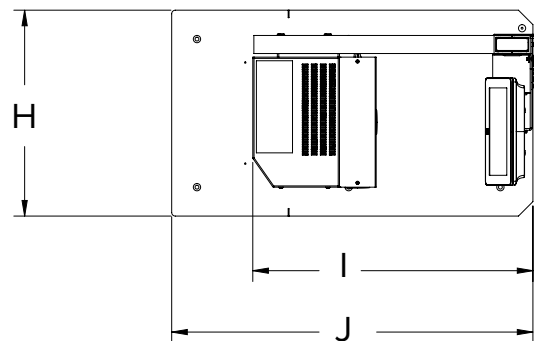
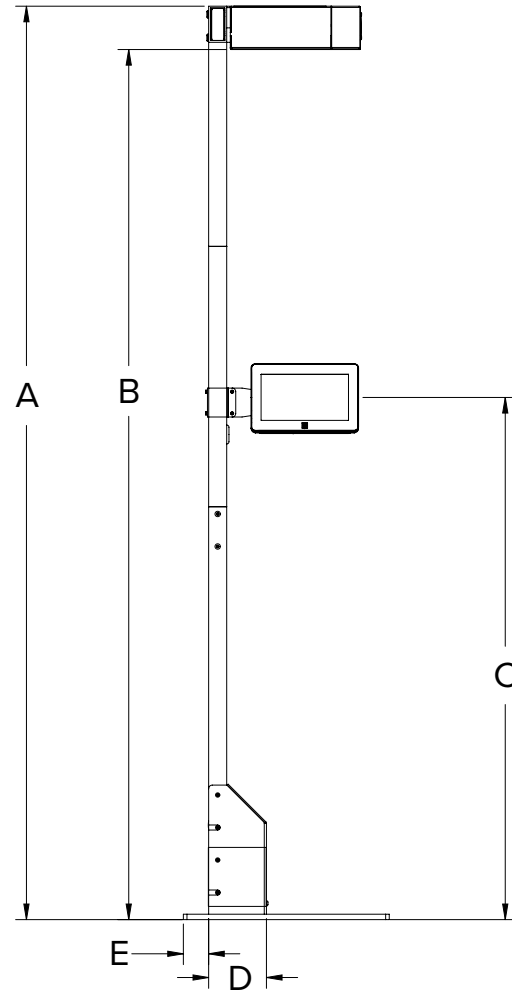
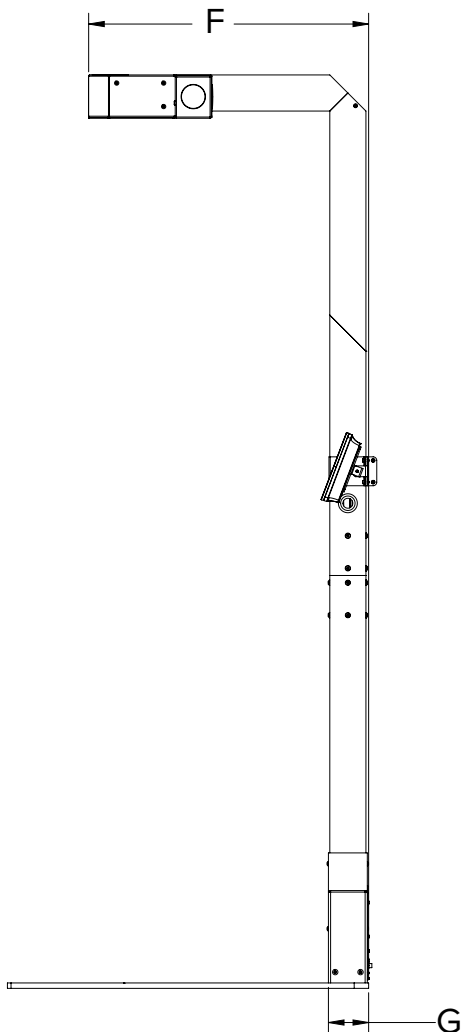

iDimension® Plus / Plus XL

Static Dimensioning System

DIMENSIONING

Dimensions

iDimension Plus XL Scanning Head Assembly					
A	9.00 in (229 mm)	F	0.60 in (15 mm)	K	3.00 in (76 mm)
B	8.50 in (216 mm)	G	1.60 in (41 mm)	L	M4 × 0.7 threaded hole
C	7.20 in (183 mm)	H	1.50 in (38 mm)		
D	3.30 in (84 mm)	I	4.50 in (114 mm)		
E	2.00 in (51 mm)	J	1.50 in (38 mm)		

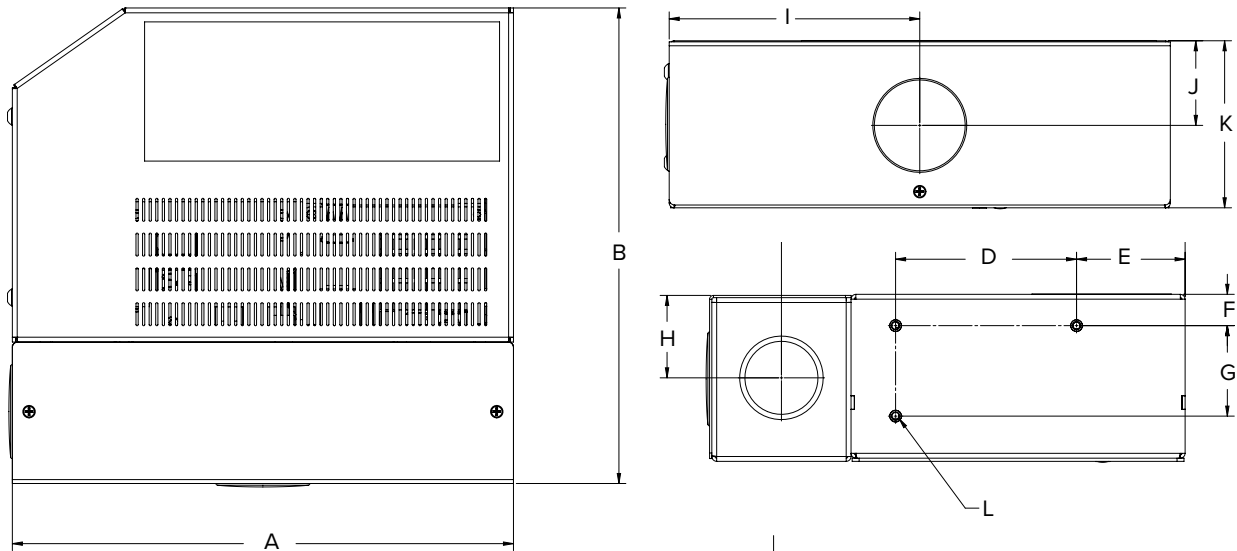

Dimensions

iDimension XL Mounting Bracket - PN 198708	
A	7.37 in (187 mm)
B	4.12 in (105 mm)
C	3.14 in (80 mm)
D	2x Ø.28
E	3x Ø.19

Use this bracket to mount iDimension XL Scanner head to the optional floor stand 174660 or to user provided structure

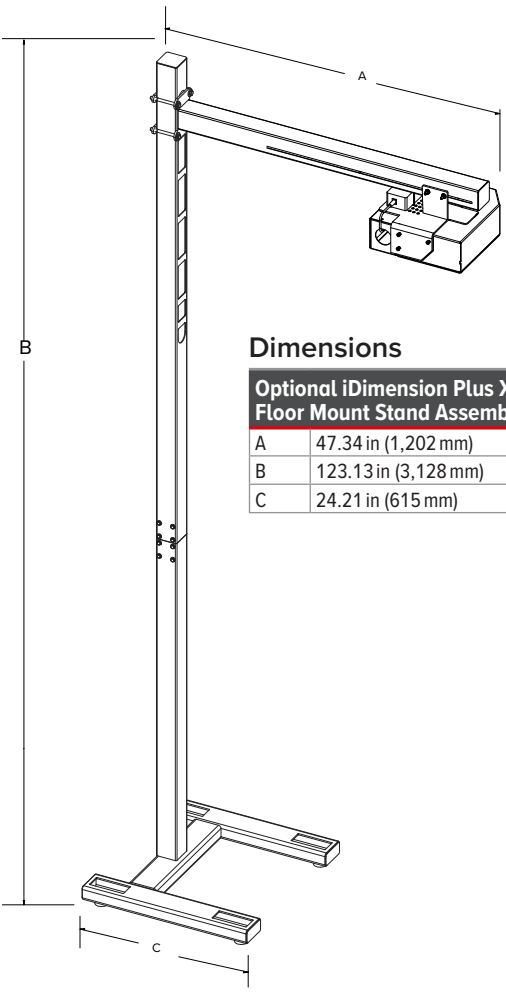
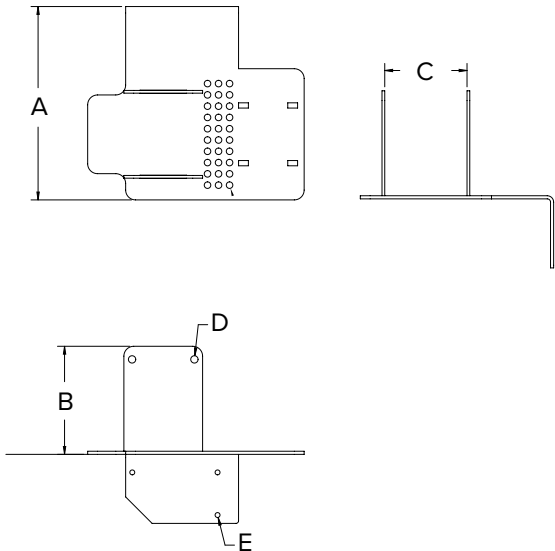

Dimensions

Optional iDimension Plus XL Floor Mount Stand Assembly	
A	47.34 in (1,202 mm)
B	123.13 in (3,128 mm)
C	24.21 in (615 mm)

iDimension® Plus Mobile Cart

Mobile Parcel System

DIMENSIONING



30in with PowerSwap
Nucleus Lithium Power System



48in with Sealed
Lead Acid Power System

iDimension Plus & scale
not included

Standard Features

- Push handle with laptop shelf, waste basket, 6 × 2 in rubber wheels with two locking casters, integrated power system and power strip

Specifications

Color:

Black powder coat

Overall Cart Capacity:

125 lb (57 kg), not including iDimension Plus and scale

Battery Type:

PowerSwap Nucleus® Lithium Power System

Output: 120 watts (1 battery)

240 watts (2 batteries)

Surge Power: 550/825 watts

Charge Time: 4-5 hours

Weight: Single battery 11 lbs

(5 kg)

Dimensions: 6.5 × 12.8 × 6.4 in

(165 × 326 × 163 mm)

Dimensions of power dock and charging Station:

17.75 × 11.63 × 10 in

(451 × 295 × 254 mm)

Sealed Lead Acid Power System

Output: 450 watts

Surge Power: 900 watts

Charge Time: 8 hours

Weight: 103 lb (46.8 kg)

Dimensions: 18.25 × 11 × 13 in

(464 × 302 × 330mm)

Part Numbers/Price

Part #	Description	Est. Weight	Price
203934*	30 in (762 mm) long Atlas Series cart	310 lb	\$5,295.00
203935*	48 in (1,219 mm) long Atlas Series cart	330 lb	\$5,895.00
PowerSwap Nucleus Lithium Power System			
212177	Kit includes: dual pocket docking station, dual pocket charging station and 2 batteries on cart		\$6,295.00
212179	Kit includes: single pocket docking station, dual pocket charging station and 1 battery on cart		\$4,395.00
Sealed Lead Acid Power System			
212180	PowerPack Mega Series PP12 sealed lead acid battery with internal charger and US power cord		\$2,270.00

Rice Lake Weighing System recommends using only the BenchPro Model BP1214 due to the overall cart capacity

*Select cart size and battery type to complete your solution.

Dimensions

30 Inch Cart	
A	27.00 in (686 mm)
B	63.50 in (1,613 mm)
C	26.00 in (660 mm)
D	33.00 in (838 mm)
E	49.00 in (1,245 mm)
F	12.00 in (305 mm)
G	20.00 in (508 mm) (adjustable shelf)

Dimensions

48 Inch Cart	
A	27.00 in (686 mm)
B	63.50 in (1,613 mm)
C	26.00 in (660 mm)
D	33.00 in (838 mm)
E	67.00 in (1,702 mm)
F	12.00 in (305 mm)
G	44.00 in (1,118 mm) (adjustable shelf)

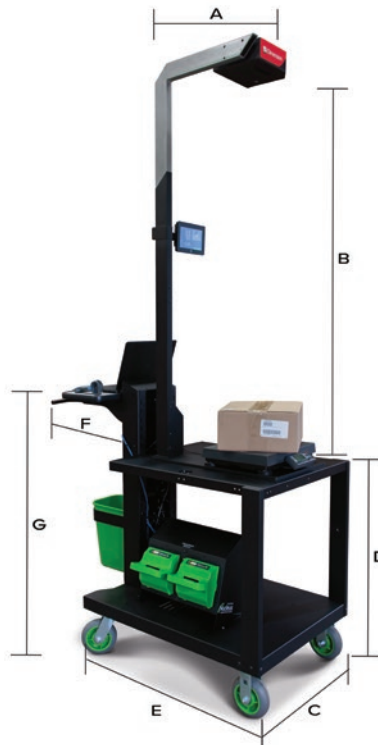

iDimension® Flex Series

Parcel and Pallet Static Dimensioning System

DIMENSIONING

NEW



Approvals



Suspended or Free-standing mount options available
Picture represents a 7ft opening on a free-standing unit

Part Numbers/Price

Part #	Description	Price
Two-Sensor Array - Cuboidal		
219295	Free-standing 80/20 frame, two-sensors, one camera, industrial PC, kiosk, software integration tool kit, REST API	\$25,000.00
219293	Modular kit, suspend from ceiling/wall, two-sensors, one camera, industrial PC, kiosk, software integration tool kit, REST API. Mounting hardware sold separately	\$22,000.00
Four-Sensor Array - Cuboidal and Irregular		
219294	Free-standing 80/20 frame, four-sensors, one camera, industrial PC, kiosk, software integration tool kit, REST API	\$27,500.00
219292	Modular kit, suspend from ceiling/wall, four-sensors, one camera, industrial PC, kiosk, software integration tool kit, REST API. Mounting hardware sold separately	\$25,000.00

Options/Accessories

Part #	Description	Price
Accessories		
200168	2.4 mm POE network camera	\$875.00
219194	Kiosk pedestal base	\$895.00
220137	Mounting kit to attach kiosk to 219294 free-standing Flex	\$250.00
212260	Kiosk shelf for printer or scanner	\$350.00
220146	Optional 5th sensor to assist with scanning black stretch film	\$2,795.00
219618	Two-sensor array 80/20 mounting kit, 25 ft high max ceiling height	\$2,795.00
205283	Four-sensor array 80/20 mounting kit, 25 ft high max ceiling height	\$3,295.00
188757	Four-sensor array aircraft wire kit for ceiling less than 35 ft	\$1,795.00
214187	RoughDeck floor scale 5 x 5 ft HC, 2,500 kg, flat black paint, Measurement Canada Certified	\$2,645.00
213921	RoughDeck floor scale 5 x 5 ft HP, 5,000 lb, flat black paint, NTEP Certified	\$2,645.00
86873	Bumper guard, HP 5 ft	\$180.00
213999	RoughDeck ramp, 5 ft	\$860.00
200183	680 Plus Indicator, LED display, 115 to 230 VAC with RJ45, US power cord. Alternately, choose a Rice Lake 880 or 1280 for automation applications.	\$1,125.00

Standard Features

- Available with two or four sensors
- Floor mounted free-standing frame, or suspend from the ceiling
- One high resolution camera (one additional camera available)
- Install/integrate with a floor scale, conveyor or pallet stretch wrapper
- Easy two-person assembly

Options

- Kiosk pedestal base available
- Second high resolution camera
- Additional sensor to assist reading black stretch film

Specifications

Power Requirements:

110 to 240 VAC
25 ft (7.62 m) U.S. power cable included

Communication Ports:

Ethernet TCP/IP, USB, Serial RS232

Operating Temperature:

14 °F to 104 °F (-10 °C to 40 °C)

Humidity:

0 to 90% non-condensing

Measurement Capability four-sensor:

Min: 12 x 12 x 12 in (300 x 300 x 300 mm)
Max: 72 x 72 x 96 in (1,828 x 1,828 x 2,438 mm)

Warranty:

Two-year limited
Five-year limited, sensors only

Approvals:

NTEP
OIML
CE Marked
FCC
MID Certified

Applications

Two-Sensor Array - Cuboidal

- Used above a work surface or over a conveyor to dimension large cuboidal packages and boxes.

Four-Sensor Array - Cuboidal and Irregular

- Pallet dimensioning, above a target zone, scale, conveyor or stretch wrapper to dimension cuboidal and irregular freight.



iDimension Flex Series Kiosk

iDimension® Flex Series

Parcel and Pallet Static Dimensioning System

DIMENSIONING

Options/Accessories

Part #	Description	Price
Barcode Scanner		
176307	QuickScan QD2131 barcode scanner	\$305.00
206229	Honeywell wireless long-range TCP/IP barcode scanner kit	\$2,695.00
Factory Service and Support		
194215	Annual licensing fee	\$800.00
FLD-Install	iDimension field install/training day, travel and expenses not included	\$1,395.00
202029	Hourly rate scheduled integration services remote session	\$145/hr
Extended Warranty – Two-year standard		
202033	iDimension Flex/PWD/LTL additional one-year extended warranty	\$1,200.00

Dimensions

iDimension Flex	
A	145.38 in (3,693 mm) max
B	93.00 in (2,362 mm)
C	104.88 in (2,664 mm) max
D	105.00 in (2,667 mm) max
E	85.08 in (2,161 mm)

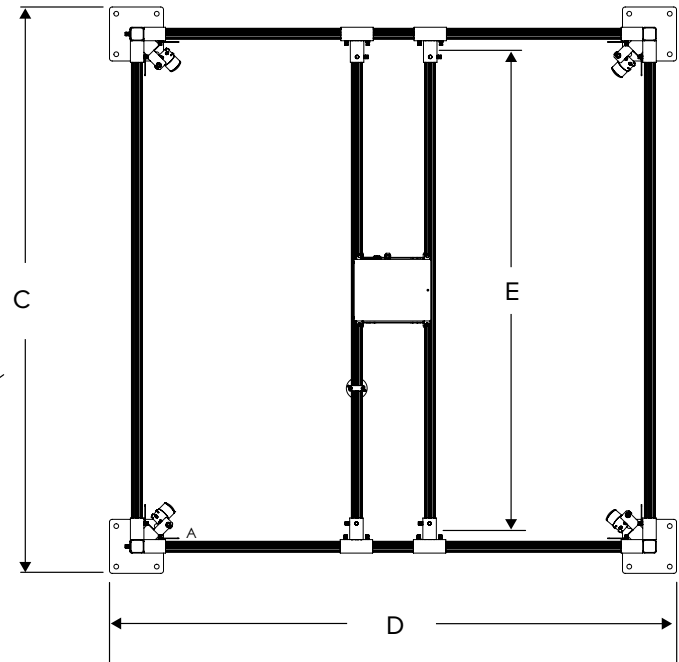
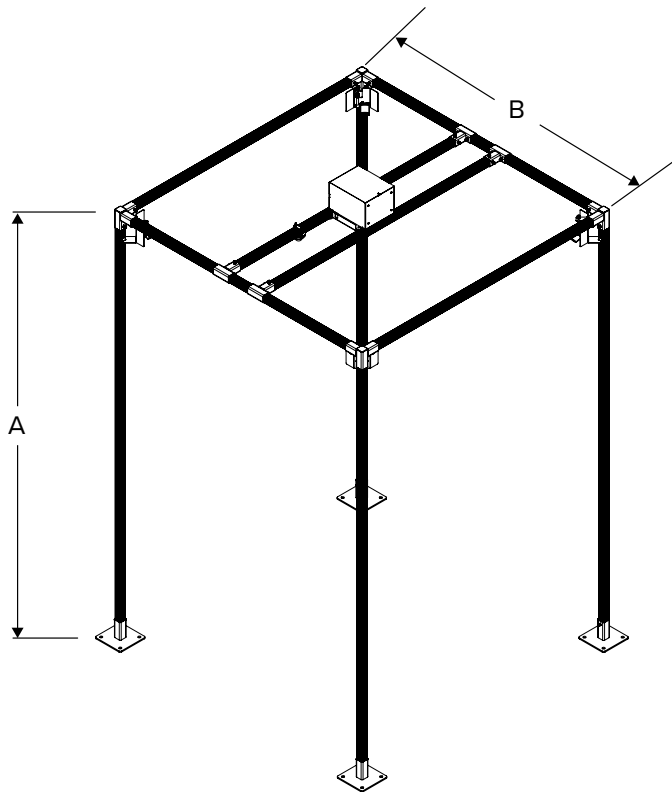

iDimension® PWD System

Pallet Weighing and Dimensioning System

DIMENSIONING



Standard Features

- Includes: iDimension PWD, kiosk, panel mounted scale indicator, 5 × 5 ft 5,000 lb scale, calibration object, accuracy test box, operators and assembly manuals
- Integrated 5 × 5 ft floor scale, 5,000 lb capacity
- Pallet tare mode can measure objects on a pallet by excluding the pallet from the measurement (not Legal for Trade)
- Simple API network integration through HTTP requests, status checking and XML parsing
- Assembly and installation in less than a day
- One high resolution camera (one additional camera available)

Options

- Second high resolution camera
- Bar code scanner and/or printer
- Access ramps for pallet jack access
- Overhead fifth sensor recommended for dimensioning highly reflective, IR sensitive or black pallet shrink wrap

Software Integration Tools

- iDimension Desktop Wedge
- Simple API network integration through HTTP requests, status checking and XML parsing
- iDimension SS for storing data, images and transferring data to ERP and WMS systems

Specifications

Legal for Trade Measurement Range:

Maximum:
72 × 72 × 72 in
(1,829 × 1,829 × 1,829 mm)

Minimum:
6 × 6 × 6 in
(152 × 152 × 152 mm)

Measurement Increment:

0.5 in (1 cm)

Performance Characteristics:

Weight and dimensions in two seconds or less
Most surfaces are captured; transparent/translucent and glossy surfaces may provide a variance

Item Placement:

Centered on floor scale for best performance

Minimum Pallet Height:

4.25 in (108 mm) wood pallets

Shapes:

Solid shapes, 3 in (76 mm) protrusions will be included in dimensions

Lighting Conditions:

Operates in any indoor lighting environment

Power Requirements:

110 to 240 VAC
with 25 ft (7.62 m) power cable included

Operating Temperature:

14 °F to 104 °F (-10 °C to 40 °C)

Humidity:

0 to 90% non-condensing

Warranty:

Two-year limited
Extended warranty available for purchase

Packaging Dimensions:

Crate 1: 101 × 80 × 30 in; 1,690 lb
(2,566 × 2,032 × 762 mm)
Crate 2: 83 × 68 × 35 in; 900 lb
(2,109 × 1,728 × 889 mm)

Approvals:

NTEP 19-076
OIML

Approvals



Part Numbers/Price

Part #	Description	Price
199318	iDimension PWD System, NTEP approved with 5,000 × 1 lb capacity floor scale (Available with OIML approved scale)	\$38,995.00

Options/Accessories

Part #	Description	Price
System Options		
200168	Second high resolution 2.4 mm POE network camera	\$875.00
199665	iDimension PWD pallet jack ramp	\$945.00
199666	Optional 5th overhead sensor	\$2,095.00
212260	Kiosk shelf for optional scanner and printer	\$350.00
Scanner, Printer and Digital Remote I/O Options		
206229	Wireless Honeywell long-range TCP/IP scanner kit for use with iDimension SS Software	\$2,695.00
176307	QuickScan QD2131 USB barcode scanner	\$305.00
192721	Zebra ZD420D printer, direct thermal	\$745.00
37345	Label, roll 5 in dia, 1 in core	\$24.00
Optional Integration Solutions		
203010*	iDimension Desktop Wedge (Windows 10 required)	N/C
175812	iDimension SS (software suite) web server software (Windows 10 required)	\$2,250.00
Factory Service and Support		
194215	Annual licensing fee	\$800.00
FLD-INSTALL	iDimension field install and training/day, travel and expenses not included	\$1,395.00
202029	Hourly rate scheduled integration services remote session	\$145.00
Extended Warranty – Two-year standard		
202033	iDimension Flex/PWD/LTL additional one-year extended warranty	\$1,200.00

Dimensions

PWD System					
A	117.34 in (2,980 mm)	F	85.56 in (2,173 mm)	K	131.86 in (3,349 mm)
B	103.14 in (2,620 mm)	G	65.00 in (1,651 mm)	L	89.18 in (2,265 mm)
C	65.00 in (1,651 mm)	H	85.56 in (2,173 mm)	M	72.22 in (1,834 mm)
D	163.00 in (4,140 mm)	I	115.66 in (2,938 mm)	N	64.25 in (1,632 mm)
E	92.70 in (2,355 mm)	J	125.41 in (3,185 mm)		

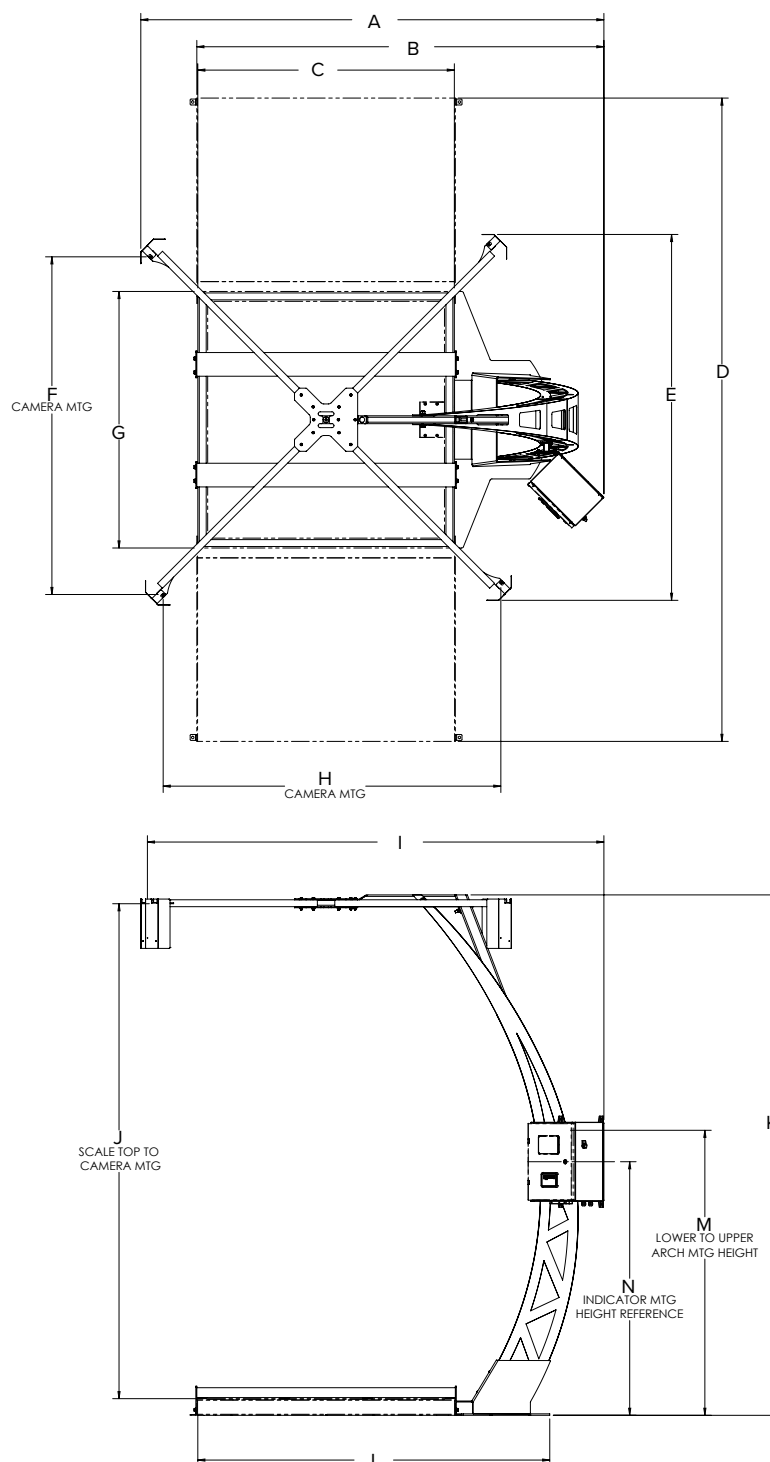

iDimension® LTL / LTL XL

Pallet Dimensioning System

DIMENSIONING

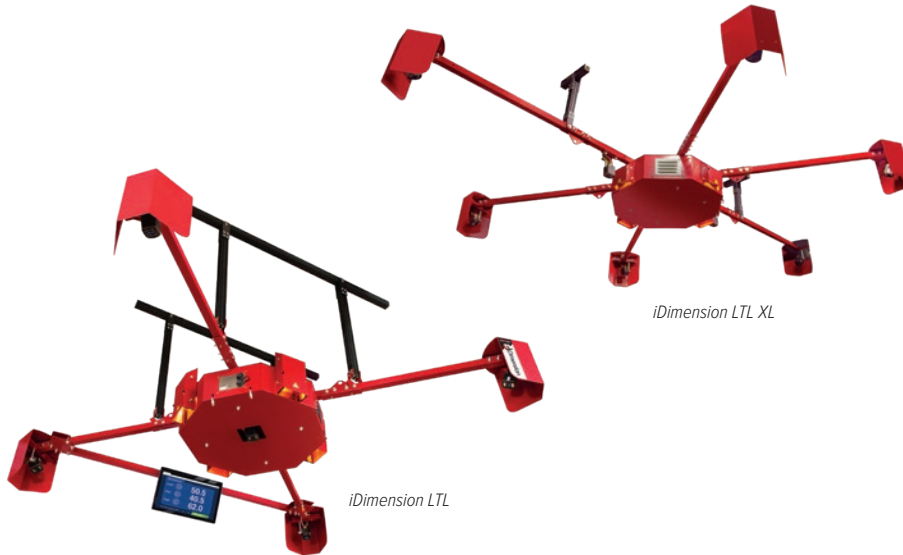

Approvals



Part Numbers/Price

Part #	Description	Price
194205	iDimension LTL	\$51,300.00
202974	iDimension LTL XL	\$59,750.00

Options/Accessories

Mounting Options		
188446	iDim LTL modular install kit	\$2,995.00
205283	80/20 ceiling mount kit (25 ft ceiling max)	\$3,295.00
206007	iDimension LTL cross bracing, for ceilings 18 to 25 ft	\$420.00
188757	Aircraft cable ceiling mounting kit (35 ft ceiling max)	\$1,795.00
System Options		
188755	2.4 mm POE network camera – second high resolution camera	\$875.00
195284	LED target zone light kit	\$1,795.00
193830	LTL 21.5 in forklift operator display kit	\$2,995.00
205286	LTL-XL 21.5 in commercial forklift operator display kit	\$2,995.00
206543	iDimension LTL light tree kit	\$1,280.00
174132	50 ft AC power cord	\$45.00
PC Options		
205073	12 in HMI PC and Ram mount kit for desk or wall	\$6,500.00
202214	HMI PC overhead Ram mounting kit on iDimensioner LTL	\$215.00
205287	HMI PC overhead Ram mounting kit on iDimensioner LTL XL	\$215.00
174659	HMI PC floor stand and guard rail kit	\$1,250.00
212433	7 in HMI PC and Ram mounting kit for forklift	\$3,250.00
Optional Integration Solutions		
203010**	iDimension Desktop Wedge (Windows 10 required)	N/C
175812	iDimension SS (software suite) web server software (Windows 10 required)	\$2,250.00
201447	iDimension SS real-time status display desktop app (Stop & Go)	\$250.00
201448	iDimension SS standalone forklift data management web app (Stop & Go)	\$250.00
Scanner, Printer and Digital Remote I/O Options		
206229	Wireless Honeywell long-range TCP/IP scanner kit	\$2,695.00
192721	Zebra ZD420D printer, direct thermal	\$745.00
37345	Label, roll 5 in dia, 1 in core	\$24.00

Standard Features

- 360° fork truck access for easy pallet placement in the target zone
- Displays dimensions in 0.2 seconds
- Minimal set up and training required
- Bounding box images identify measurement record
- One high resolution camera

Options

- Second high resolution camera
- Target zone LED light kit
- 23 inch operator display provides instantaneous feedback to the forklift or pallet jack operator
- iDimension SS for storing data and images transferring data to ERP and WMS systems
- Stop/go activation

Specifications

Power Requirements:

- 110 to 240 VAC
- 25 ft (7.62 m) power cable included

Measurement Increment:

- 0.5 in (10 mm)

Dimensioning Speed:

- Within 2 seconds from trigger to scan complete

Performance Characteristics:

- Most surfaces are captured, including black plastic shrink wrap. Transparent/translucent and glossy surfaces may provide a variance.

Stop & Go Measurement

Performance Characteristics:

- Stop-trigger-go 2 seconds for Legal for Trade results. Best when used with a Rice Lake Legal for Trade forklift scale.

Item Placement:

- Single pallet within the center of the target zone for best performance

Minimum Pallet Height:

- 4.25 in (108 mm) wood pallets

Minimum Ceiling Height:

- 12.75 ft

Shapes:

- Solid shapes, 3 in (76 mm) protrusions will be included in dimensions

Lighting Conditions:

- Operates in any indoor lighting environment

Legal for Trade Measurement Range:

- (L × W × H)
- Maximum freight size:
96 × 96 × 96 in
(2,438 × 2,438 × 2,438 mm)
- Minimum freight size:
12 × 12 × 12 in
(305 × 305 × 305 mm)

Operating Temperature:

- 14 °F to 104 °F (-10 °C to 40 °C)

Humidity:

- 0 to 90% non-condensing

Warranty:

- Two-year limited
- Sensors: five-year limited (extended warranty available for purchase)

Approvals:

- NTEP 19-076
- OIML
- MID
- FCC
- CE

Part Numbers/Price

Part #	Description	Price
iDimension LTL Stop and Go		
198480	Stop/go activation license key	\$7,000.00
212337	Universal Class II forklift carriage 34 in Stop & GO reflector plate (Not for Yale forklifts)	\$225.00
193858	Rice Lake CLS forklift scale Stop & GO reflector plate	\$145.00
Floor Scale Options		
213921	RoughDeck floor scale, 5 x 5 ft HP, 5,000 lb, flat black paint, NTEP Certified	\$2,645.00
214187	RoughDeck floor scale, 5 x 5 ft HC, 2,500 kg, flat black paint, Measurement Canada Certified	\$2,645.00
213922	RoughDeck floor scale 5 x 7 ft HP, 5,000 lb, flat black paint, NTEP Certified	\$3,125.00
86820	Bumper guard, HP 7 ft	\$395.00
86873	Bumper guard, HP 5 ft	\$180.00
213999	RoughDeck ramp, 5 ft	\$860.00
200183	680 Plus Indicator, LED display, 115 to 230 VAC with RJ45, US power cord. Alternately, choose a Rice Lake 880 or 1280 for automation applications.	\$1,125.00
Factory Service and Support		
194215	Annual software maintenance	\$800.00
FLD-INSTALL	iDimension field install and training/day, travel and expenses not included	\$1,395.00
202029	Hourly rate scheduled integration services remote session	\$145.00
Extended Warranty – Two-year standard		
202033	iDimension PWD/LTL additional one-year extended warranty	\$1,200.00

*Requires factory support and training on first installation of iDimension LTL

*Available for free download at www.ricelake.com

Dimensions -

iDimension LTL XL	
A	178.28 in (4,528 mm)
B	34.00 in (864 mm)
C	150.44 in (3,821 mm)
D	131.83 in (3,348 mm)
E	12.64 in (321 mm)

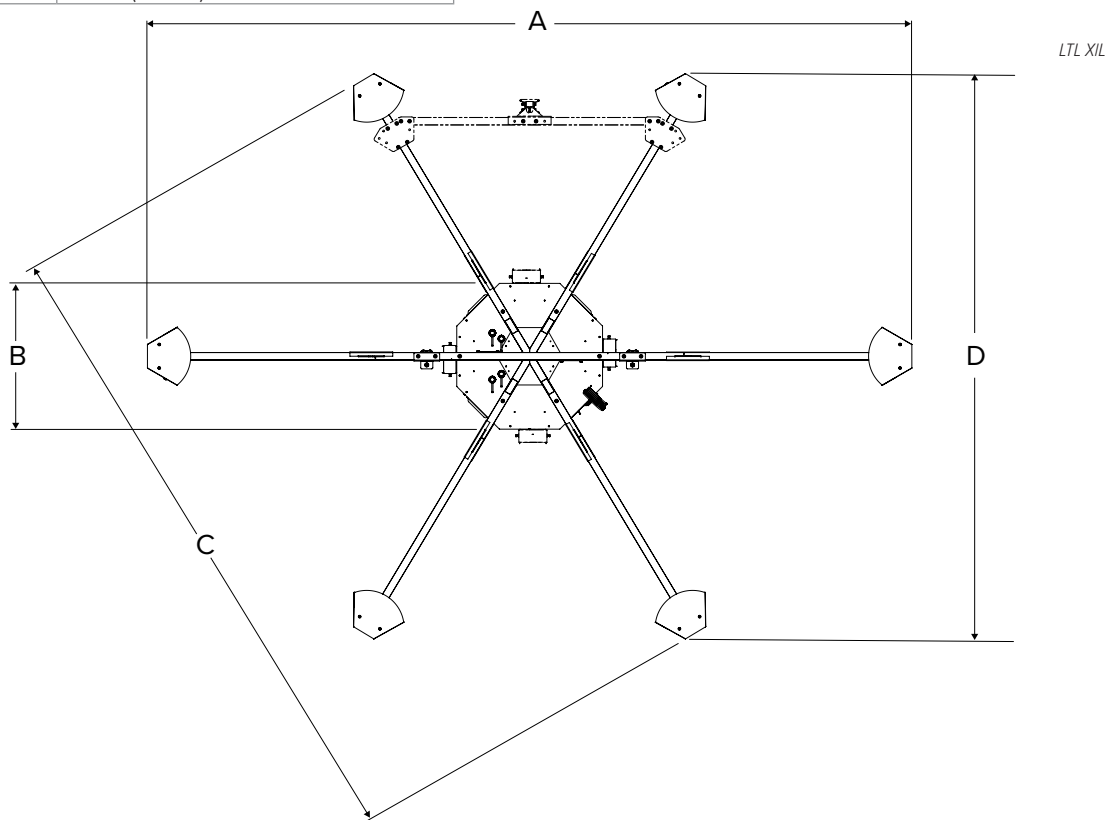
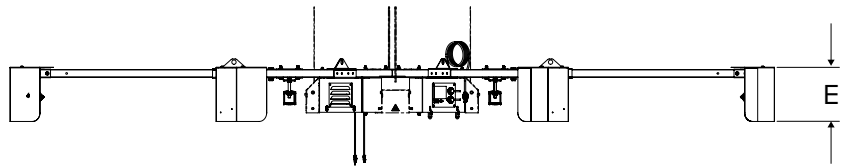

iDimension® LTL / LTL XL

Pallet Dimensioning System

DIMENSIONING

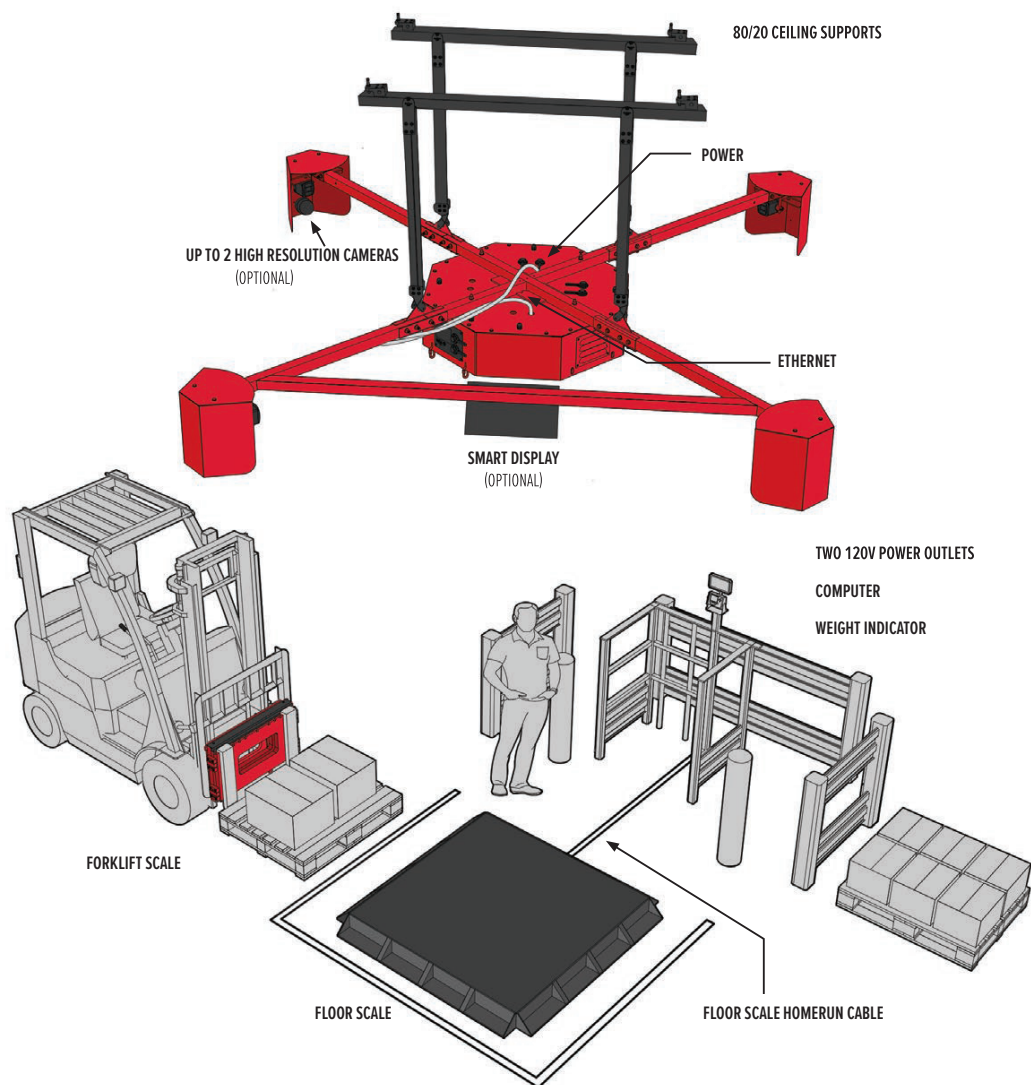

System Overview

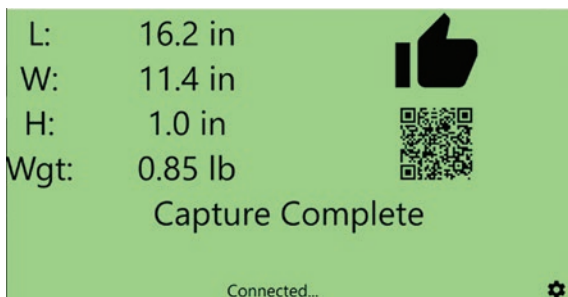
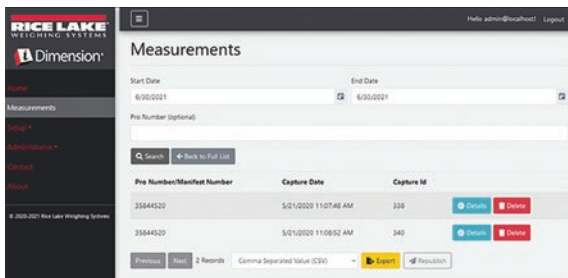
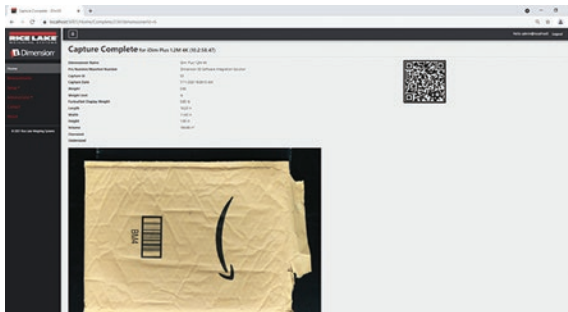
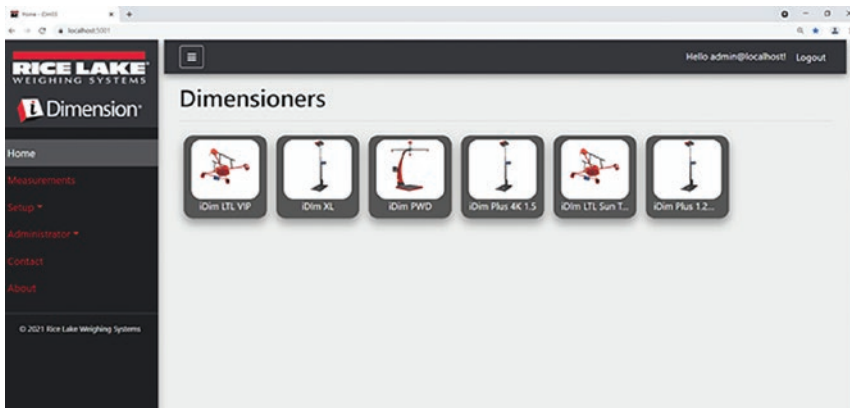

iDimension SS is a robust, dynamic application for managing scan data captured by iDimension Dimensioning Solutions.

Standard Features

- Real-time data access and triggering via REST API Swagger API development toolkit included
- Supported peripherals include bar code scanners and label printers
- Measurement database – configurable for capturing and transferring:
 - Identification #, i.e. Pro or sales order number
 - Dimensions L x W x H
 - Scale or manual keyboard entry weight
 - Volume
 - Three configurable user fields
 - Color high resolution images
 - Bounding box images
 - Volumetric conversion
 - Email notification alerts
 - Error logging
- Digital remote I/O configuration for use with PLCs
- Shipping method analyzer for girth and volume analysis thresholds in conjunction with the iDimension SS real-time display desktop application
- Local data storage
- Automatic data export, options include FTP and SMB, configurable
- Data export, including image format composition and annotations available in data export provides output in CSV, JSON, XML and TXT file formats
- QR code display for alternate input into MRP, TMS and WMS systems
- Error logging with high resolution image capture
- Role-based security model protects data and prevents unwanted configuration changes
- Comprehensive application log files available to download
- Forklift database for use with Stop & Go

SQLite database maximum size capabilities is dependent upon file system type.

System Requirements

- Windows 10 build 1607 or newer (64-bit only)
- 2.0 GHz processor or faster
- 250 MB hard disk space needed for install
- 8 GB RAM or greater
- Ethernet TCP/IP communication to dimensioning devices plus optional scanners, printers and Rice Lake Weighing 680, 880 and 1280 scale indicators
- A supported web browser (Chrome, Microsoft Edge, Firefox, Safari)

Part Numbers/Price

Part #	Description	Price
203010***	iDimension Desktop Wedge (Windows 10 required)	N/C
175812	iDimension SS (software suite) web server software (Windows 10 required)	\$2,250.00
201447	iDimension SS real-time status display desktop app (stop & go)	\$250.00
201448	iDimension SS standalone forklift data management web app (stop & go)	\$250.00

*** Available for free download at www.ricelake.com

