

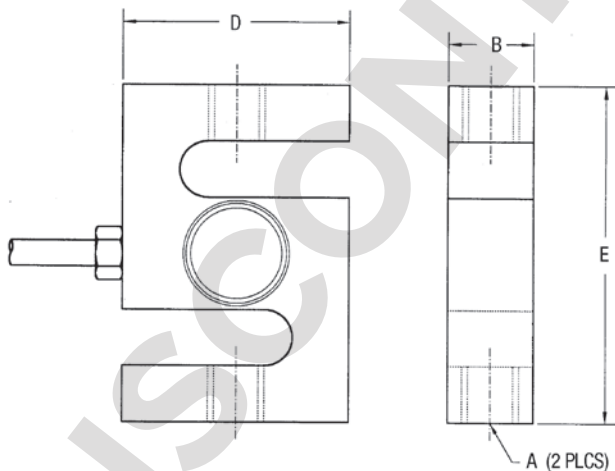

Picture is a representation of actual product

### Dimensions

| Rated Capacity  | A          | B    | D    | E    |
|-----------------|------------|------|------|------|
| <b>lb/in</b>    |            |      |      |      |
| 500 to 3,000    | 1/2-20 UNF | 1.00 | 2.00 | 2.97 |
| 5,000 to 10,000 | 3/4-16 UNF | 1.00 | 3.00 | 4.25 |



### Weigh Module Available

RICE LAKE WEIGHING SYSTEMS

ITCM-Isolated

Tension Cell Mount.....page 34

### Specifications

**Full Scale Output:**

2.0 mV/V

**Output Resistance:**

350 (± 3) ohm

**Input Resistance:**

385 (± 5) ohm

**Material/Finish:**

Stainless steel

**Temperature:**

Operating: 0 °F to 150 °F (-18 °C to 65 °C)

**Seal Type:**

Welded-seal, IP67

**Safe Overload:**

150% full scale

**Rated Excitation:**

5 to 15 VDC

**Combined Error:**

0.05%

**Insulation Resistance:**

5,000 megohm

**Cable Length:**

20 ft

**Cable Diameter:**

0.200 in

Polyurethane jacket

**Cable Color Code:**

Red +Excitation

Black -Excitation

Green +Signal

White -Signal

**Warranty:**

One-year limited