

Ishida Uni-7 and WM-Nano Label Cassette Adjustment

Product: Ishida Uni-7 Series Scales and WM-Nano Wrapper

Issue: Poor print and grinding gears

Cause: Catch magnet out of position

Solution: Adjust catch magnet



Authorized distributors and their employees may view or download this document from the Rice Lake Retail Solutions distributor site at www.ricelake.com/retail.

Issue

There is an adjustable catch magnet on the bottom front of the Uni-7 label cassette. The purpose of the catch magnet is to keep the cassette in place. However, if the catch magnet is out of position, it can cause poor printing and, in some cases, can damage the cassette's drive gears.



Figure 1. Uni-7 Label Cassette Catch Magnet

If the catch magnet is set too far back (away from the operator) the cassette does not seat correctly. This results in misalignment of the thermal print head and print roller, causing poor print quality.

If the alignment is only slightly off, the poor printing may be intermittent. When the catch magnet is too far out of position, the print will be light and the gears will grind as they do not fully mesh.

Procedure

Adjust the catch magnet as required.

Other Repairs

If any of the cassette's gears are damaged they should be replaced.

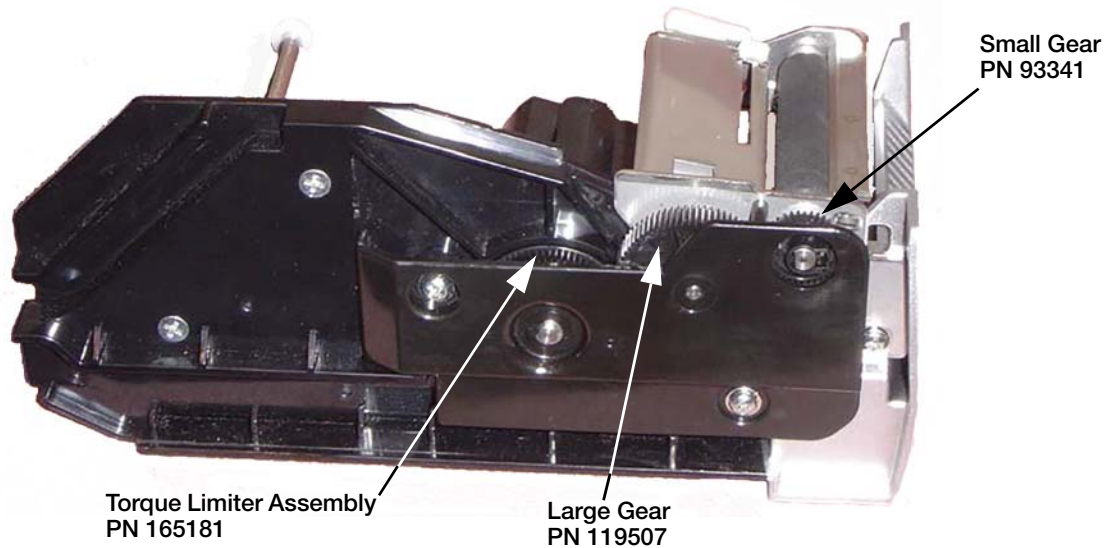

Figure 2. Gears



© Rice Lake Weighing Systems Specifications subject to change without notice.
Rice Lake Weighing Systems is an ISO 9001 registered company.

230 W. Coleman St. • Rice Lake, WI 54868 • USA
U.S. 800-472-6703 • Canada/Mexico 800-321-6703 • International 715-234-9171 • Europe +31 (0)26 472 1319

www.ricelake.com/retail

www.ricelake.mx

www.ricelake.eu

www.ricelake.co.in