

MSI-9600 Port-A-Weigh Crane Scale

Retrofit Kit Installation Instructions

The MSI-9600 Retrofit Kit updates the MSI-9300 and MSI-9300HT to the most current configuration. Generation information is located on the serial tag.



Manuals are available from Rice Lake Weighing Systems at www.ricelake.com/manuals

Warranty information is available at www.ricelake.com/warranties

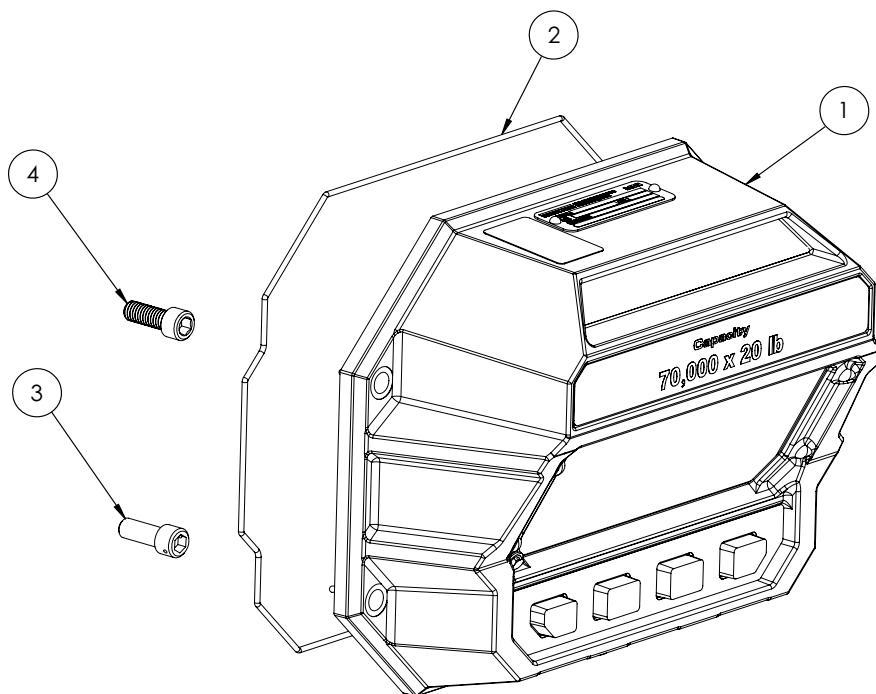

Figure 1. MSI-9600 Retrofit Kit Parts Diagram

Item No.	Part No.	Description	Qty
1	213677	Front Casting Assembly LED Display 9600	1
2	147996	O-ring Assembly Front/Back Casting	1
3	133598	Screw Seal 3/8-16 x 1 SS Drilled Head	1
4	91869	Screw, Cap 3/8-16NC x 1 Hex Socket Head	3
	142574	Screw HH BLK 6-32 1/4	1
	213679	Bulkhead Assembly 9600	1
	147997	O-ring Assembly Bulkhead	1
	149679	Tag Serial Number	1
	146005	Screw Seal 6-32 x 5/16	2
	214630	Overlay, Descriptive 9600	1
	143272	Washer Seal #6 Steel	1
	145962	Screw RH 4 x 1/4 U Type Drive Plated	2
	148218	Label Warning Crane Scale	1

Table 1. MSI-9600 Retrofit Kit Parts List

1.0 Removing the Existing Front Casting



WARNING: Ensure that all power has been removed prior to starting the procedure.

1. Turn the MSI-9600 off.
2. Remove the front casting by loosening the screws securing it. See [Figure 2](#).
3. Unplug the load cell and power cables from the front casting or bulkhead. Discard casting and hardware.

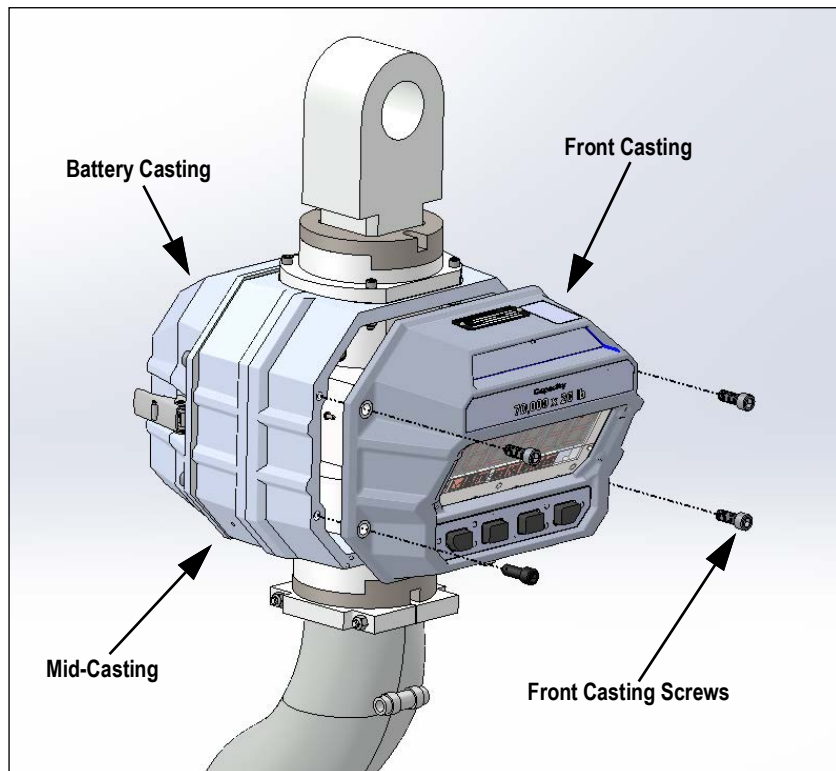

Figure 2. Front Casting Removal

2.0 Reassembling the Unit

1. Place the o-ring in the groove on the bulkhead of the front casting. Ensure bulkhead correctly aligns with the front casting.
2. Reconnect the load cell and power cables to the supplied front casting.
3. Place the front casting assembly on mid-casting assembly and secure with the supplied 3/8 inch drive head screws, torqued to 20–25 ft-lbs (see [Figure 2](#)).
4. Calibrate the unit, see the technical manual (PN 218164) for the calibration procedure.



© Rice Lake Weighing Systems Content subject to change without notice.

230 W. Coleman St. • Rice Lake, WI 54868 • USA USA: 800-472-6703 • International: +1-715-234-9171