

# TRANSEND

WIRELESS LOAD CELL INTERFACE

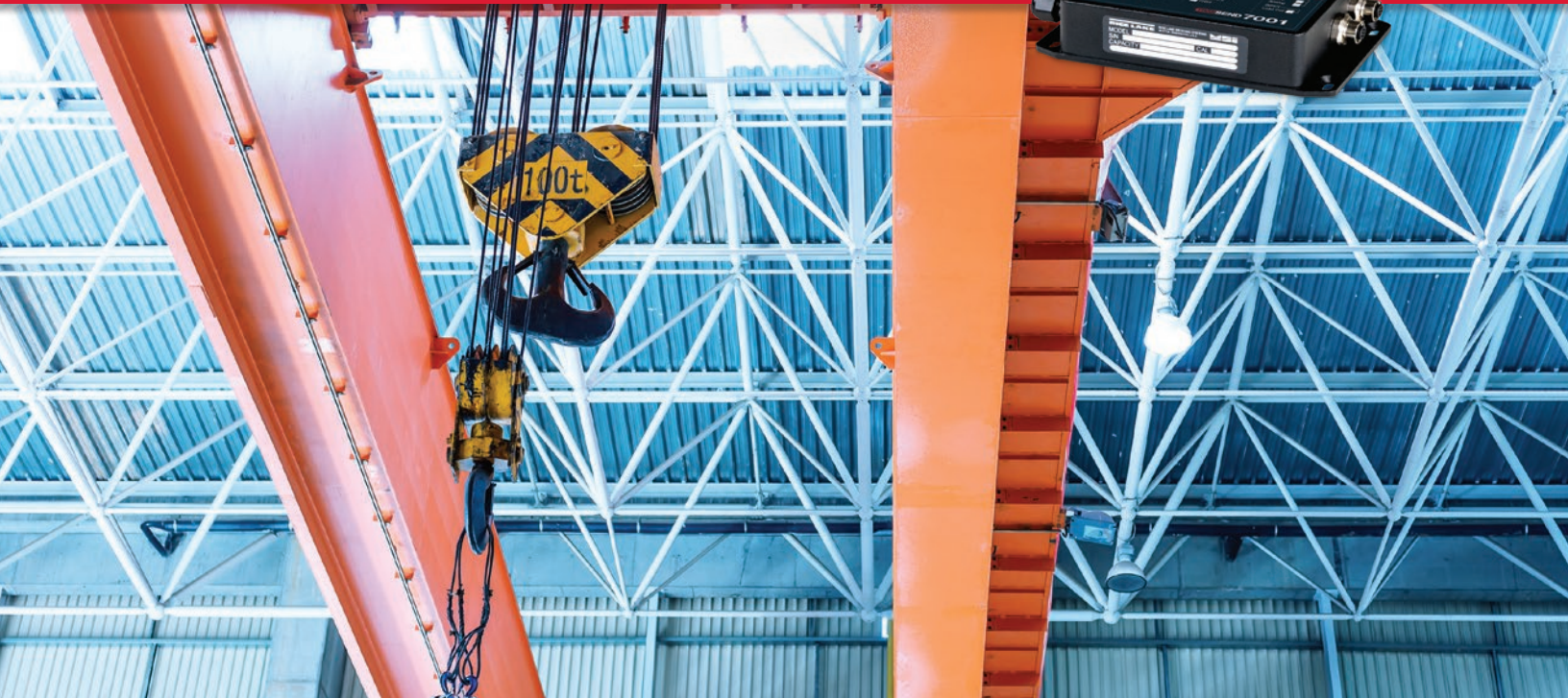

**RICE LAKE**<sup>®</sup>  
WEIGHING SYSTEMS

800-472-6703

[www.ricelake.com](http://www.ricelake.com)

# Efficient Communication. Easy Operation.

From initial scale weights to final numeric values on indicators, communication between devices is critical for operations. Livestock, tank, crane and other weighing processes rely on connections to keep facilities moving. If hardwired cabling is damaged or needs replacement, communication is halted and processes are stalled. TranSend transforms the way devices communicate by removing the risk of hardwired cables.

Designed to wirelessly transmit from one or more load cells, TranSend works with MSI's integrated weighing solutions. It's compatible with a broad range of receiving devices including MSI-8000, MSI-8000HD, MSI-8004HD, digital weight indicators, PC, PLC and other industrial devices.

A rugged, die-cast aluminum, IP68 enclosure is perfect for most industrial environments. TranSend is suitable for most indoor and outdoor environments with an operating distance of up to 300 feet.

Select from the basic functionality of single-channel models or the expanded capabilities of multi-channel models. Multi-channel devices offer up to three optional relay contacts, an audible alarm and function as a wireless junction box. In the event of a load cell failure, TranSend can transmit a service warning for the load cell until it is repaired.

Upgrade your processes with TranSend to unlock simple, reliable wireless communication.

## Overhead Weighing

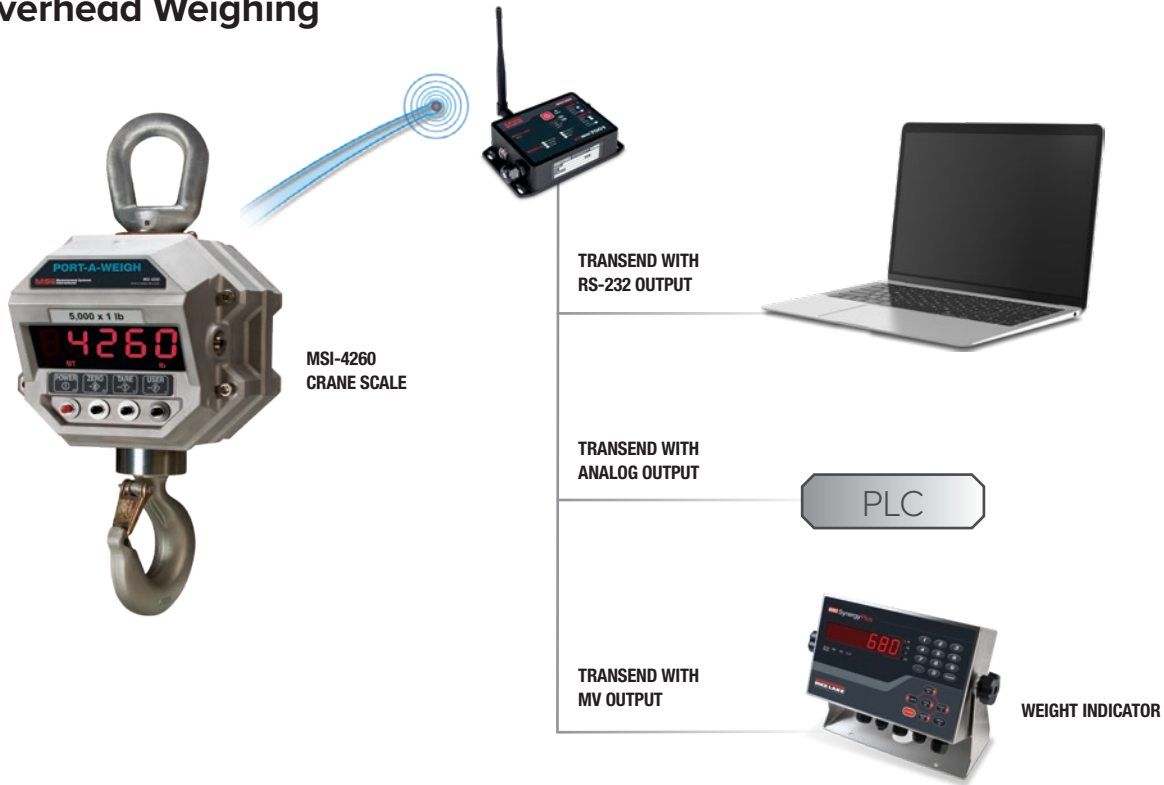

# Livestock Weighing

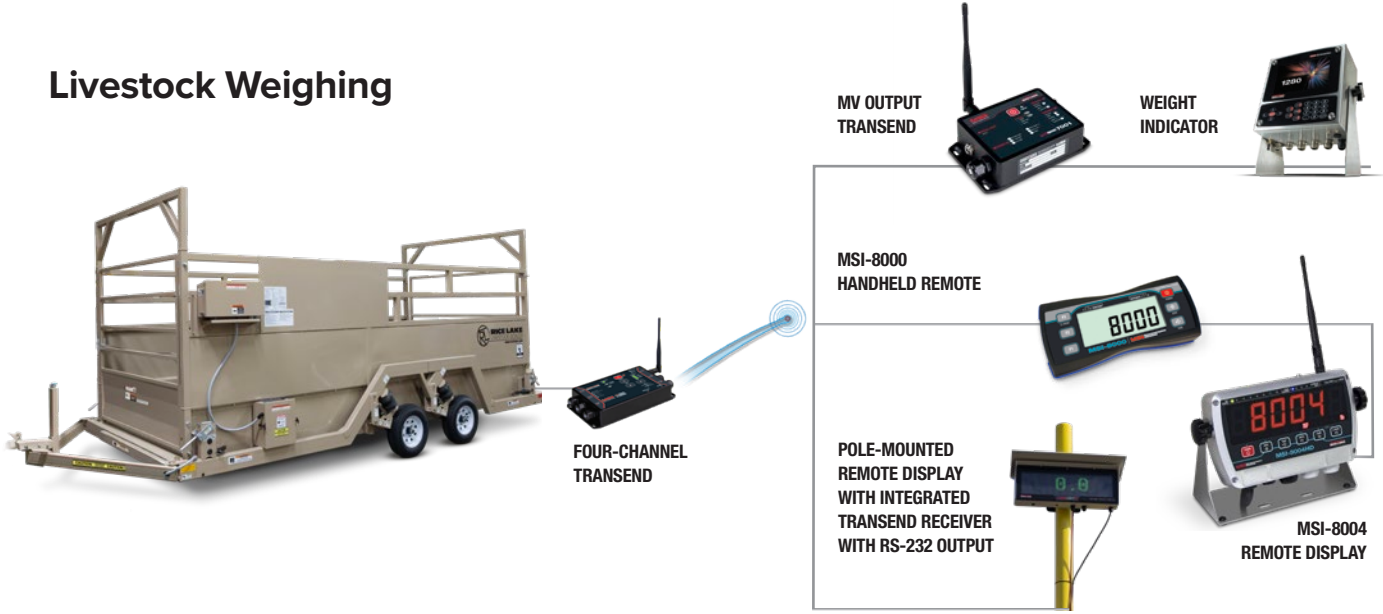

# Tank Weighing

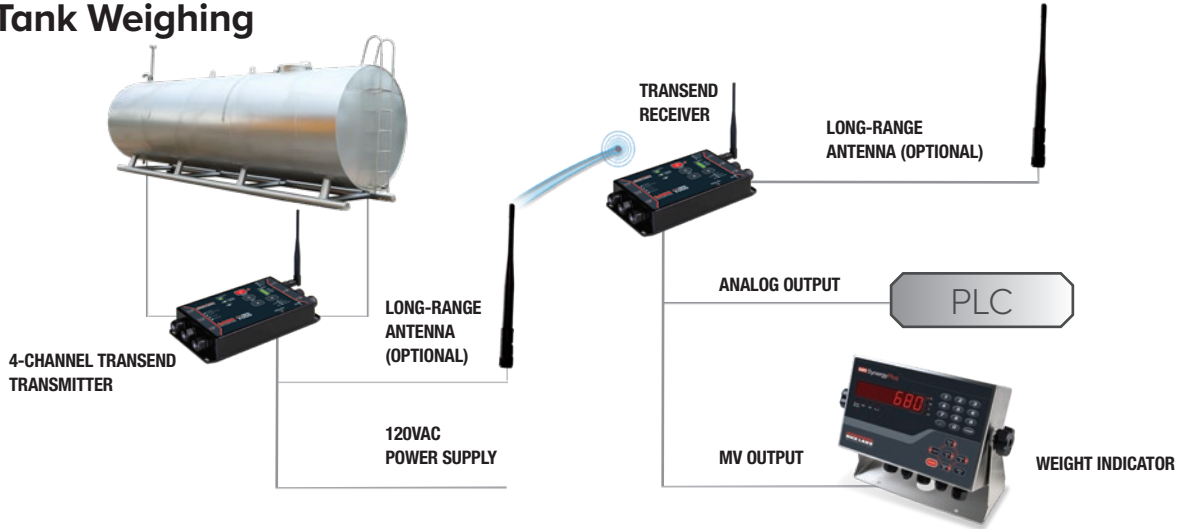

# In-block Weighing

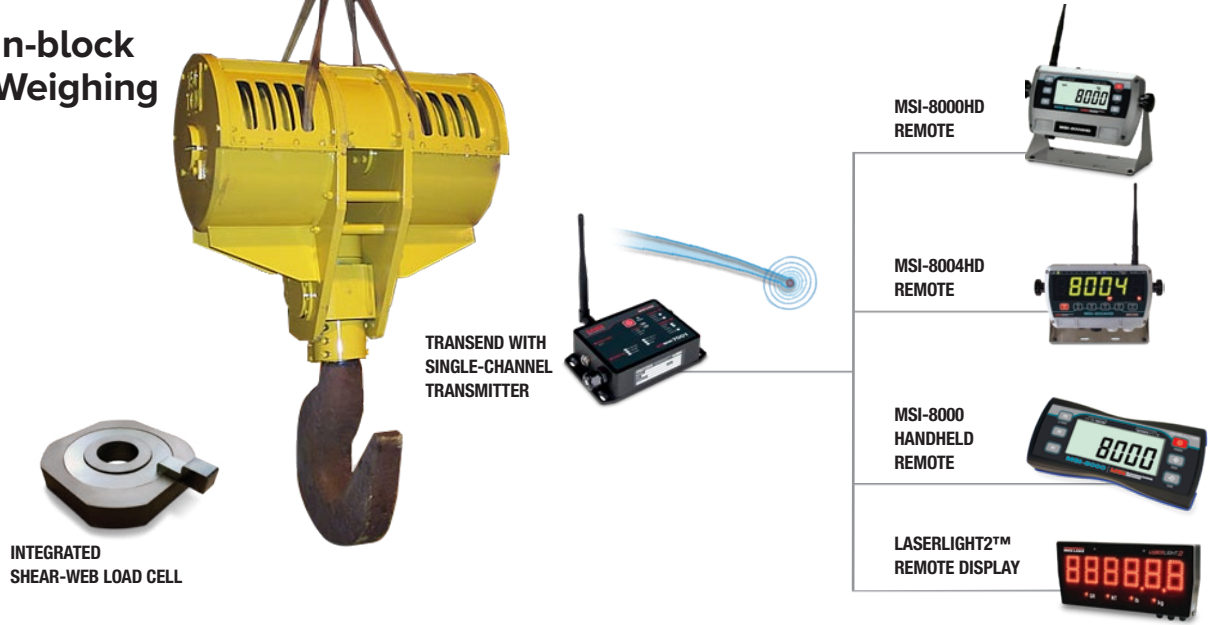

# TRANSEND

## WIRELESS LOAD CELL INTERFACE

### SPECIFICATIONS

<b>RESOLUTION:</b>	Up to 10,000 d available
<b>ENCLOSURE:</b>	7000/7001: Aluminum, black, powdered-coated
<b>RATING:</b>	7000/7001: NEMA 4, IP-68 rated
<b>KEYS/BUTTONS:</b>	7000 Models: POWER, ZERO, UP/DOWN keys 7001 Models: POWER
<b>UNITS:</b>	lb, kg, t, tn, kN
<b>ANNUNCIATORS:</b>	Power on LED 7000 Models: Four status LEDs for load cell zero/fault, 1 per channel, 3 setpoint status LEDs 7001 Models: Power, two channel LEDs
<b>POWER INPUT:</b>	90-264 VAC, 120-300 VDC
<b>OPERATING TEMPERATURE:</b>	-40° F to 185° F (-40° C to 85° C)
<b>AUTO-OFF MODE:</b>	Off, 15, 30, 45, 60 (selectable)
<b>AUTO SLEEP MODE:</b>	Off, 15, 30, 45 & 60 minutes (selectable), powers up with key press or weight change
<b>SERVICE COUNTERS:</b>	>25% capacity and >100% capacity
<b>EVENT COUNTER:</b>	>User defined loads
<b>LOAD CELL/SCALE INPUTS:</b>	7000 Models: Four load cell/scale channels with digital summing 7001 Models: Up to two load cell inputs with summing
<b>EXCITATION VOLTAGE:</b>	4.8VDC, 16 x 350 ohm or 32 x 700 ohm load cells/mV/V Converter
<b>EXCITATION:</b>	3VDC or ±1.4VDC minimum, 12VDC or ±6VDC maximum
<b>DIGITAL FILTERING:</b>	OFF, LO, Medium and HI selectable
<b>RADIO OPTIONS:</b>	Direct sequence spread spectrum @ 2.4 GHz, license free 802.15.4, Wi-Fi, FHSS
<b>RADIO LINK EFFECTIVE RANGE:</b>	Up to 300' typical
<b>STANDARD ANTENNA:</b>	½ wave 2dBi, articulated
<b>RF/EMI SHIELDING:</b>	Exceeds NIST handbook 44 and CE standards
<b>DATA I/O:</b>	RS-232
<b>CONNECTORS:</b>	RS-232, 6-Pin M8

### OPTIONS/ACCESSORIES

- Load cell/junction box cable 6.5' with molded M12 connector for IP-66 protection
- Field-wireable load cell connector
- Long-range antennas
- Universal AC wall cube (Not IP-66)
- Sealed lead acid battery
- SLA battery chargers
- Internal relays (SS or Form C) switching capabilities up to 5A @ 250VAC per relay
- RS-232 serial cable (DE-9 to M8)
- Second radio modem option for 7000

### APPROVALS:



## Heavy Capacity Weighing

