

Aviation

TABLE OF CONTENTS

TRACER® AV2	46
<i>Baggage Weighing Instrumentation</i>	

The following product names, logos, brands, and other trademarks featured or referred to within this publication are the property of their respective trademark holders.

Tracer® AV2

Baggage Weighing Instrumentation



Ideal for baggage weighing, Tracer AV2 combines a sleek five-button keypad with the most durable stainless steel display. The simple-to-install display features a large, backlit LCD display and the rugged keypad will endure years of busy check-in counter use.

Tracer AV2 components consist of a control box, cables, display(s) and keypad(s). Complete your system with a BenchMark™ LP or BenchMark HD scale.

Standard Features

- Customer display (panel mount), control box supports two RD-2 displays
- Five-button keypad for ticket agent
- Accumulation function
- Display indicates overweight bag alarm

Approvals



Part Number/Price

Part #	Description	Price
202532	Tracer AV2, Single LCD Panel Mount Display, Single Keypad	\$1,945.00
202531	Tracer AV2, Dual LCD Panel Mount Display, Single Keypad	\$2,345.00
207287	Tracer AV2, Dual LCD Panel Mount Display, Dual Keypad	\$2,445.00
204452	Tracer AV2, Single LCD External Mount Display, Single Keypad	\$1,995.00
204451	Tracer AV2, Dual LCD External Mount Display, Single Keypad	\$2,495.00

To complete your system, refer to page 201 for the BenchMark LP or page 202 for the BenchMark HD scales

Replacement Parts

Part #	Description	Price
205206	Tracer AV2 Controller	\$1,045.00
207288	Kit, RD-2A LCD display, panel mount packaged	\$445.00
207289	Kit, RD-2A LCD display, external mount packaged	\$495.00
207290	Kit, five-button keypad	\$195.00
15438	Power cord, detachable, 7.5 ft long	\$20.00
203937	Power supply, 7.5V 30W	\$155.00
207302	Cable splitter, DB9 female to DB9 male connector	\$10.00

Specifications

- Power:**
115/230 VAC to control box 50-60 Hz
- Power Consumption:**
6 W
- Excitation Voltage:**
5 VDC, 8 x 350Ω
- Analog Signal Input Range:**
-0.5 mV/V to +4.5 mV/V
- Analog Signal Sensitivity:**
1 μV/graduation recommended
- A/D Sample Rate:**
6.25-120 Hz, software selectable
- Resolution:**
Internal: 8,000,000 counts
Display: 1,000,000
- System Linearity:**
Within 0.01% full scale
- Communication:**
Wi-Fi or Bluetooth® configurable
Ethernet TCP/IP
USB Device
- Status Annunciators:**
Lb/kg
- Display:**
Stainless steel, panel mounted, seven-digit LCD display, 0.8 in (20 mm) tall digits
- Keys/Buttons:**
Zero, Units, Accum, Print, Enter
- Temperature Range:**
14° F to 104° F (-10° C to 40° C)
- Dimensions:**
Panel Mount Display: 7.5 x 4.0 x 1.49 in (19.05 x 10.16 x 3.79 cm)
External Mount Display: 7.5 x 3.9 x 1.44 in (19.05 x 9.91 x 3.66 cm)
Panel Mount Keypad: 4.0 x 2.5 x 2.1 in (10.16 x 6.35 x 5.33 cm)
CPU Enclosure: 7.5 x 7.0 x 2.25 in without mounting feet
11.13 x 7.0 x 3.06 in with mounting feet
- Weight:**
5.25 lb
- Warranty:**
Two-year limited warranty
- Approvals:**
NTEP CC 21-051, Class III/III, 10,000d
Measurement Canada AM-6168
UL/cUL Listed

Tracer® AV2

Baggage Weighing Instrumentation

Dimensions

CPU Enclosure Assembly

A	7.30 in (18.55 cm)	G	7.50 in (19.05 cm)
B	5.30 in (13.47 cm)	H	11.10 in (28.20 cm)
C	7.00 in (17.78 cm)	I	2.40 in (6.10 cm)
D	3.20 in (8.13 cm)	J	10.0 in (25.40 cm)
E	8.90 in (22.61 cm)	K	4.50 in (11.43 cm)
F	8.00 in (20.32 cm)		

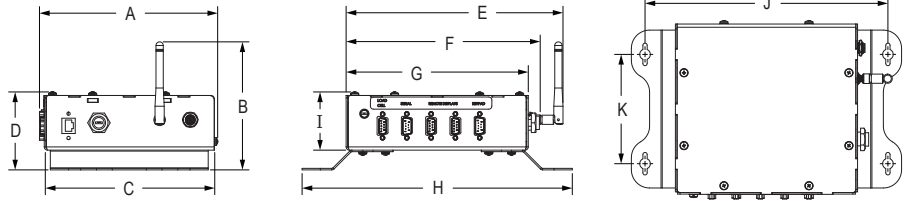

Dimensions

Remote Keypad (Panel Mount)

A	4.00 in (10.16 cm)	E	1.90 in (4.83 cm)
B	2.50 in (6.35 cm)	F	1.38 in (3.51 cm)
C	1.98 in (5.03 cm)	G	4.63 in (11.76 cm)
D	0.063 in (0.16 cm)	H	2.60 in (6.61 cm)

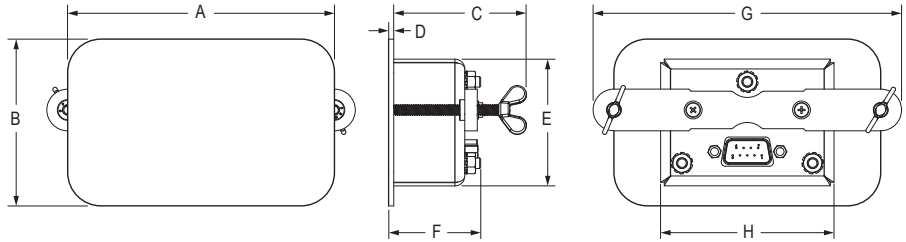

Dimensions

Remote Display (Panel Mount)

A	7.50 in (19.05 cm)	E	1.00 in (2.54 cm)
B	4.00 in (10.16 cm)	F	0.063 in (0.16 cm)
C	7.00 in (17.78 cm)	G	1.33 in (3.38 cm)
D	2.22 in (8.00 cm)	H	1.49 in (3.79 cm)

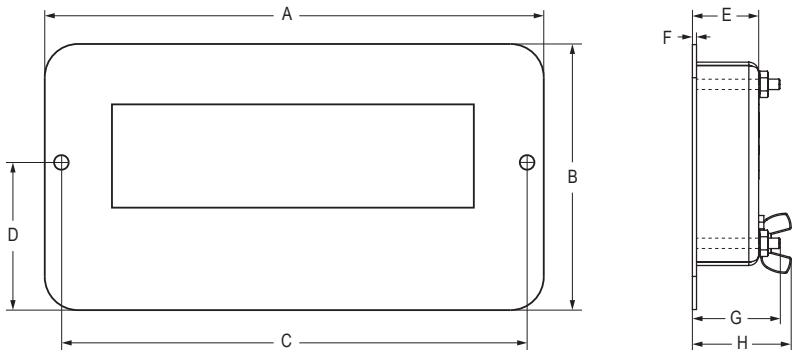

Dimensions

Remote Display (External Mount)

A	7.50 in (19.05 cm)	E	1.44 in (3.66 cm)
B	3.90 in (9.91 cm)	F	1.29 in (3.28 cm)
C	6.22 in (15.80 cm)	G	1.00 in (2.54 cm)
D	1.95 in (4.96 cm)		

