

Ishida Uni-3 Price Computing Scale with Printer

Label Gap Sensor Wire Replacement

This addendum illustrates how to replace the Label Gap Sensor Wire (PN 104832).



Disconnect power supply before servicing.

Take precaution against residual electrical charge hazard. Capacitors inside the scale may hold an electrical charge even after power is disconnected.



Manuals can be viewed or downloaded from the Rice Lake Weighing Systems website at www.ricelake.com/manuals

1. Open the *Uni-3* according to the instructions in the technical manual. Access to the CPU board is required.
2. Unplug the label sensor wire from the **XJ16** connection on the CPU board.
3. Remove cable clamp holding the sensor wire to the side wall inside of the unit. Retain for reinstallation.
4. Cut the wire tie securing the excess wire.

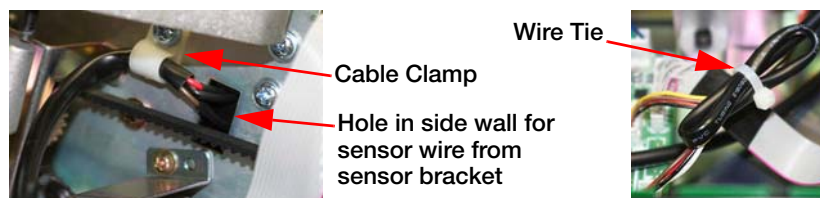

Figure 1. Cable Clip and Wire Tie

5. Loosen the screws supporting the sensor support bracket, on the inside of the side wall.
6. Remove the sensor support bracket, pulling the wire through the hole in the side wall.

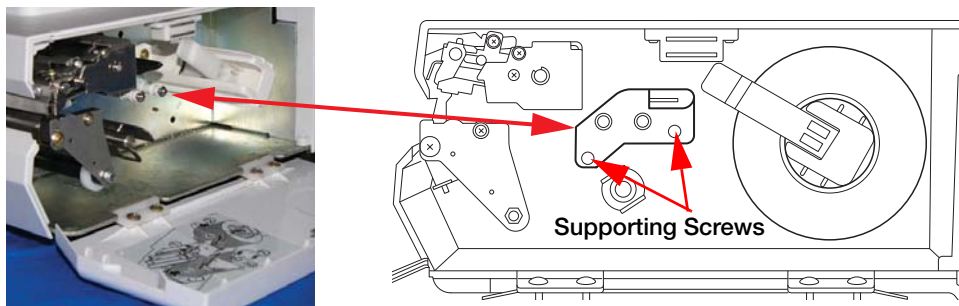

Figure 2. Remove Sensor Support Bracket

7. Using a small flat head screwdriver, gently nudge the sensor support tabs out of the sensor support bracket.

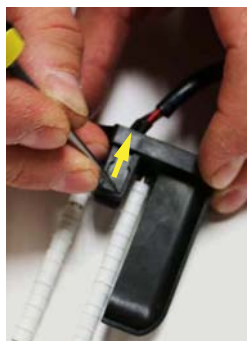

Figure 3. Support Tabs

- Pull the label sensor assembly from the support bracket and discard.



Figure 4. Insert Sensor Assembly

- Insert the sensor end of the new sensor wire into the support bracket.
- Gently push the sensor support tabs back into the support bracket.
- Ensure the sensors are all the way in and the sensor wire is secure.



Figure 5. Assembly Complete

- Thread the end of the wire into the hole in the side wall. See Figure 2.
- Align the sensor bracket to the holes in the side wall.
- Secure the sensor bracket using the original screws.
- Secure the sensor wire to the side wall using the clip retained in step 3.
- Plug the sensor into connection **XJ16** on CPU board.
- Gather excess wire and use a wire tie to bind it together.
- Reassemble the *Uni-3* according to the technical manual.



© Rice Lake Weighing Systems Specifications subject to change without notice.
Rice Lake Weighing Systems is an ISO 9001 registered company.

230 W. Coleman St. • Rice Lake, WI 54868 • USA
U.S. 800-472-6703 • Canada/Mexico 800-321-6703 • International 715-234-9171 • Europe +31 (0)26 472 1319