

880 Universal Digital Weight Indicator

Panel Mount Option

This document contains instructions to mounting the 880 Universal Digital Weight Indicator to a panel.

See the 880 indicator manual (PN 158387) for more information regarding installation procedures and requirements.



Manuals can be viewed or downloaded from the Rice Lake Weighing Systems website at www.ricelake.com/manuals

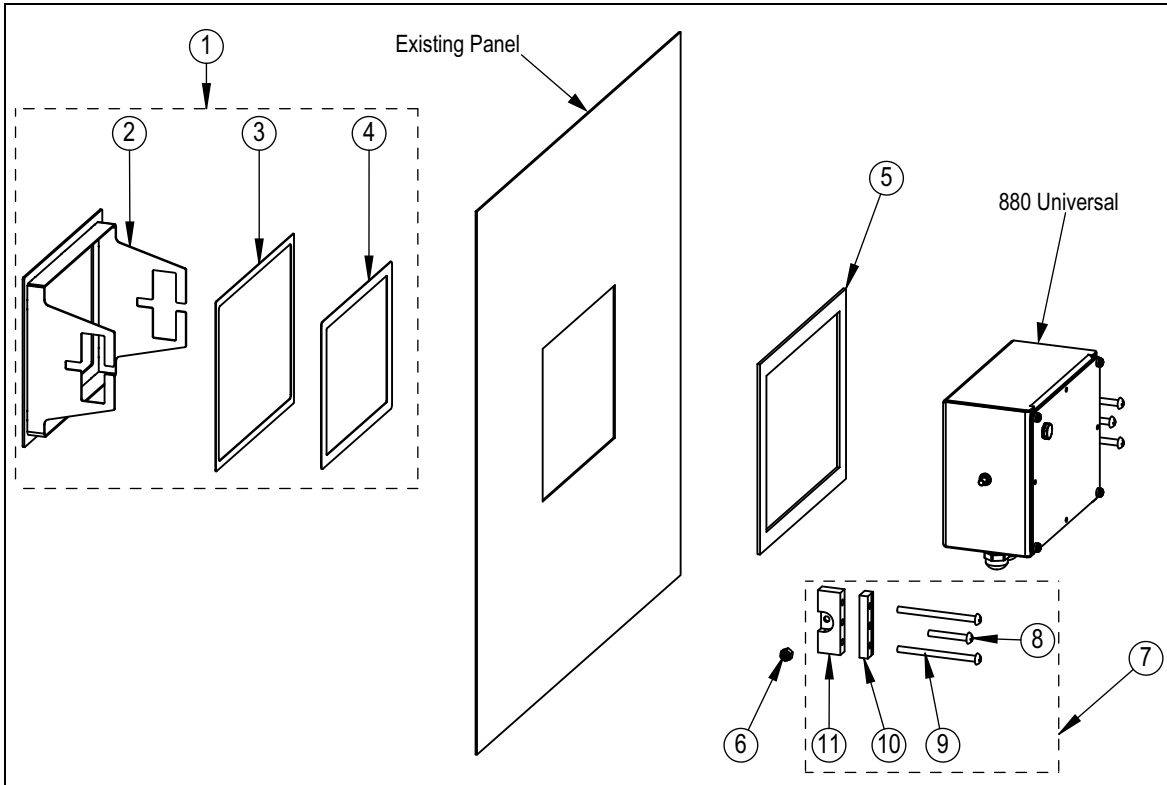

Figure 1. 880 Universal – Panel Mount Kit Parts Illustration (PN 177850)

Item No.	Part No.	Description	Qty
1	180574	Bezel Assembly, 880 Universal Panel (includes Items 2-4)	1
2	177887	Panel Mount Weldment, 880	1
3	177869	Gasket, Exterior Bezel	1
4	177870	Gasket, Interior Bezel	1
5	180558	Reinforcement Plate	1
6	14634	Nut, Lock 1/4-20NC HEX	2
7	166164	Clamp Assembly (includes items 8-11)	2
8	166184	Screw 1/4-20NC x 1 3/4"	2
9	166815	Screw 1/4-20NC x 3 1/2"	4
10	166157	Bar Clamp	2
11	166156	Plate Clamp	2

Table 1. 880 Universal – Panel Mount Kit Parts List



Procedure to install the panel mount option:



Figure 2. Remove Tilt Stand

1. Use the reinforcement plate as a template to make a cutout in the panel. Ensure cutout is far enough from panel edge to accommodate bezel. Panel mount bezel dimensions are 9.19" x 7.49" (233 mm x 190 mm).
2. Remove the tilt stand from the indicator enclosure, if attached.
3. Peel adhesive backing from the bezel gaskets, then press bezel into the panel cutout.
4. Place the reinforcing plate over the bracket from the inside of the panel.

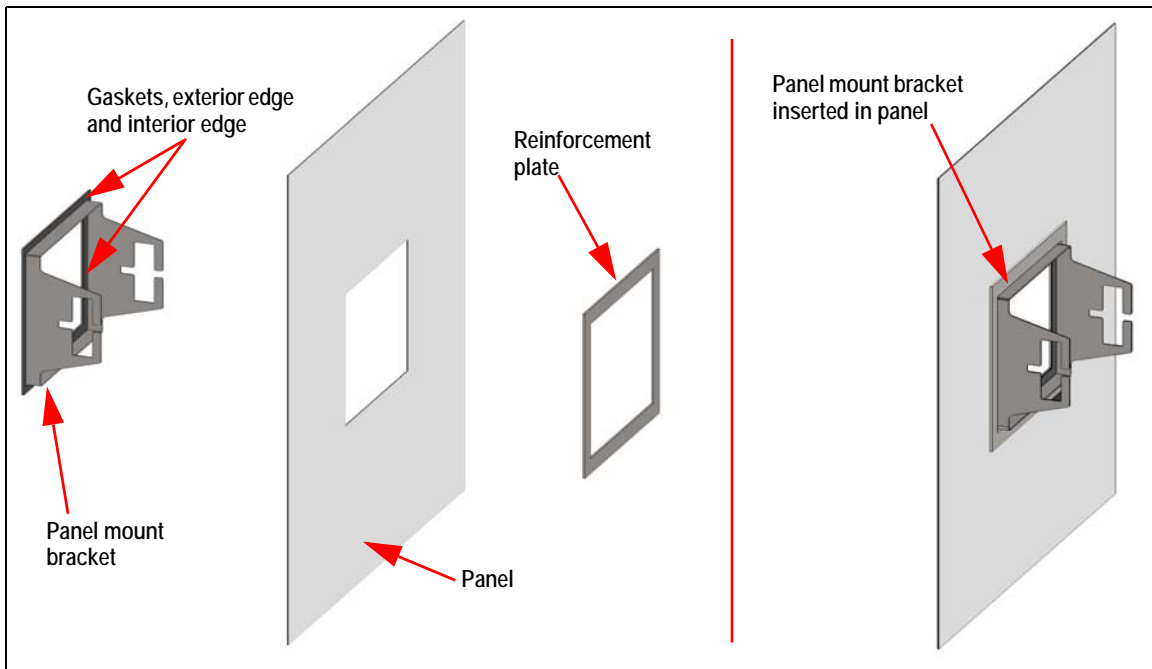

Figure 3. Install Panel Mount Option



Note *If the seal is installed properly, it is dust tight. It is not intended for wash-down applications.*

5. Use the 880 technical manual (PN 158387) to install all cabling and the back panel of the indicator.
6. Insert the indicator into the panel mount bracket from the inside of the panel. Align the mounting studs on the indicator to the slots in the bracket.
7. Place a clamp assembly over the mounting stud on one side of the indicator.
8. Secure with a lock nut on the mounting stud. Tighten only until the locking feature is engaged and the nut cannot rotate off the stud. The clamp assembly can still rotate freely on the stud. Do not over tighten, this contact must slide when the clamp is applied in [Step 9](#).

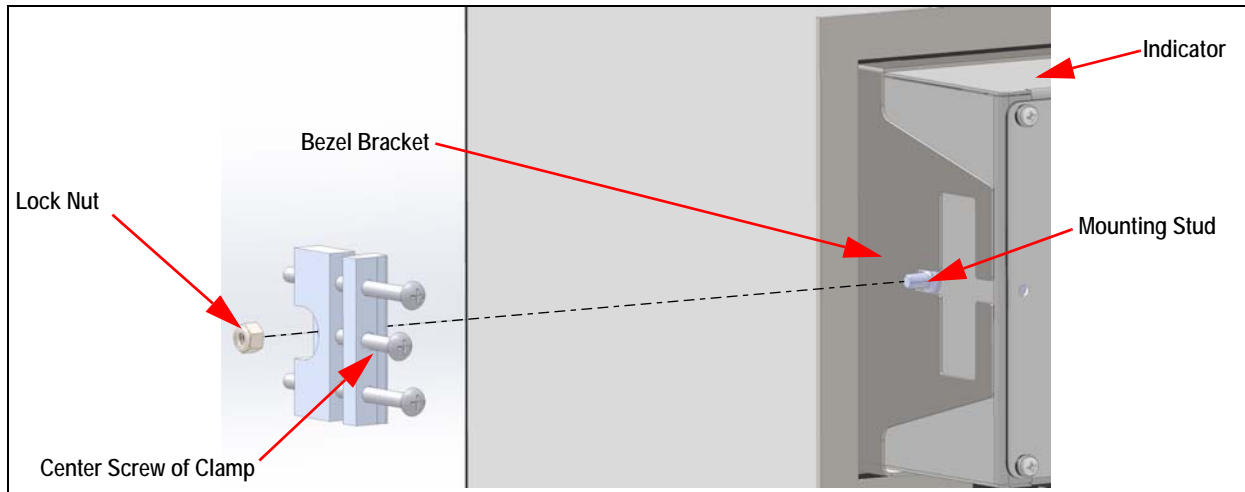

Figure 4. Install Indicator

9. Tighten the center screw of the clamp assembly until the indicator is pressed securely against the interior gasket.
10. Tighten the outer screws of the clamp assembly until the panel mount bracket is held loosely against the panel.



Note The maximum torque for steps 9 and 10 is 20 in/lb.

11. Repeat Steps 7-10 to secure the remaining clamp assembly to the indicator/panel mount bracket.

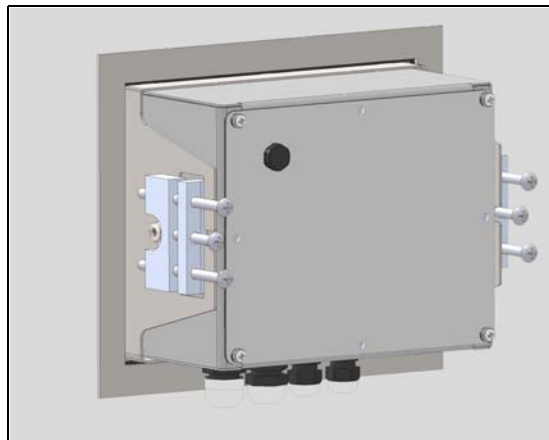

Figure 5. Tighten Clamp Assembly

12. Tighten the outer screws of both clamp assemblies until the front bezel is held securely against the front surface of the panel.

Maintenance

1. Loosen the outer screws on one clamp assembly to relieve pressure on the center screw.
2. Loosen the center screw so that the clamp assembly can be pulled out of the way of the back panel of the indicator. There is no need to completely remove the clamp assembly.
3. Remove the back panel of the indicator and perform the required maintenance as described in the indicator manual.
4. Tighten the center screw of the clamp assembly, engaging the clamp bar in the bezel bracket, until the indicator is pressed securely against the inner bezel gasket.
5. Tighten the outer screws of the clamp assembly until the front bezel is held securely against the front surface of the panel.

See the 880 indicator manual (PN 158387) for more information regarding installation procedures and requirements.



© Rice Lake Weighing Systems Specifications subject to change without notice.
Rice Lake Weighing Systems is an ISO 9001 registered company.

230 W. Coleman St. • Rice Lake, WI 54868 • USA
U.S. 800-472-6703 • Canada/Mexico 800-321-6703 • International 715-234-9171 • Europe +31 (0)26 472 1319