

**RL77032SS HE**

Stainless Steel, Hermetically Sealed, IP69K



Picture is a representation of actual product.

**Approvals****Order Information**

Load Rating	Part #	Est. Weight	Price
1,000 lb	221559	4 lb	Consult
1,500 lb	221560	4 lb	Consult
2,000 lb	221561	4 lb	Consult
2,500 lb	221562	4 lb	Consult
5,000 lb	221563	4 lb	Consult
10,000 lb	221564	7 lb	Consult
15,000 lb	221565	7 lb	Consult
20,000 lb	221566	7 lb	Consult
25,000 lb	221567	7 lb	Consult

**Dimensions**

Rated Capacity	A1	A2	B	C	D	E	F	G	CONDUIT ADAPTER
lb/in									
1,000 to 5,000	1.22	1.22	7.50	6.25	0.62	0.50	1.12	1.25	1/4-18 NPT
10,000 to 25,000	1.44	1.94	8.75	7.50	0.62	0.81	1.62	1.99	1/4-18 NPT

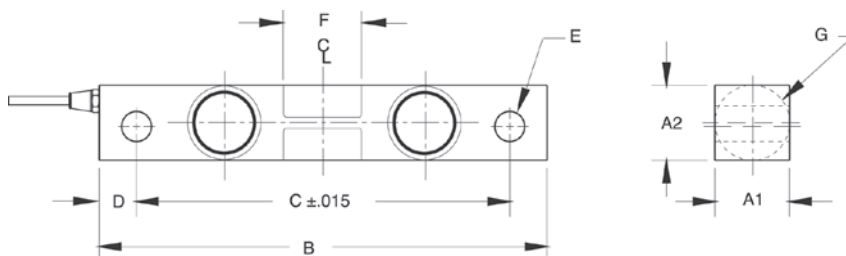
RICE LAKE  
LOAD CELLS**Interchangeable Products**

RICE LAKE WEIGHING SYSTEMS

**RL75016WHE**..... page 135

VPG® SENSORTRONICS®

**65016WH**..... page 292**Weigh Module Available**

RICE LAKE WEIGHING SYSTEMS

**RL1600 HE Series**..... page 71**Specifications****Full Scale Output:**

3.0 mV/V

**Output Resistance:**

700 (± 5) ohm

**Input Resistance:**

770 (± 10) ohm

**Material/Finish:**

Stainless steel

**Temperature:**Operating:  
0 °F to 150 °F (-18 °C to 65 °C)**Seal Type:**

Hermetically sealed, IP69K

**Safe Overload:**

150% full scale

**Safe Sideload:**

100% full scale

**Rated Excitation:**

5 to 10 VDC

**Nonlinearity:**

0.03% full scale

**Hysteresis:**

0.02% full scale

**Deflection at Capacity:**1,000 lb: 0.01 in  
5,000 lb: 0.015 in  
10,000 to 20,000 lb: 0.022 in  
25,000 lb: 0.036 in  
50,000 lb: 0.052 in  
75,000 lb: 0.07 in**Insulation Resistance:**

5,000 megohm

**Cable Length:**25 ft  
Polyurethane jacket**Cable Color Code:**Red +Excitation  
Black -Excitation  
Green +Signal  
White -Signal**Warranty:**

Two-year limited

**Approvals:**

cFMus