

TABLE OF CONTENTS

Aviation .....39

Tracer® AV2 .....40

*Baggage Weighing Instrumentation*

The following product names, logos, brands and other trademarks featured or referred to within this publication are the property of their respective trademark holders.

# Tracer® AV2

Baggage Weighing Instrumentation



## Approvals



Measurement  
Canada  
Approved



Ideal for baggage weighing, Tracer AV2 combines a sleek five-button keypad with the most durable stainless steel display. The simple-to-install display features a large, backlit LCD display and the rugged keypad will endure years of busy check-in counter use.

## Part Number/Price

Part #	Description	Price
202532	Tracer AV2, single LCD panel mount display, single keypad	\$2,060.00
202531	Tracer AV2, dual LCD panel mount display, single keypad	\$2,495.00
207287	Tracer AV2, dual LCD panel mount display, dual keypad	\$2,595.00
204452	Tracer AV2, single LCD external mount display, single keypad	\$2,110.00
204451	Tracer AV2, dual LCD external mount display, single keypad	\$2,645.00

To complete your system, refer to page 176 for the BenchMark® LP or page 177 for the BenchMark HD scales

## Replacement Parts

Part #	Description	Price
205206	Tracer AV2 CPU module	\$1,075.00
207288	Kit, RD2 LCD display	\$510.00
207289	Kit, RD2 LCD display, external mount package	\$565.00
207290	Kit, five-button keypad	\$225.00
15438	Power cord, detachable, 7.5 ft long	\$35.00
203937	Power supply, 7.5 V 30 W	\$185.00
207302	Cable splitter, DB9 female to DB9 male connector	\$11.00

## Standard Features

- Customer display (panel mount)
- CPU module
- Supports two displays (customer/agent)
- Five-button keypad for ticket agent
- Accumulation function
- Display indicates overweight bag

## Specifications

### Power:

115 to 230 VAC to CPU module  
50/60 Hz

### Power Consumption:

6 W

### Excitation Voltage:

5 VDC, 8 x 350 ohm load cells

### Analog Signal Input Range:

-0.5 mV/V to 4.5 mV/V

### Analog Signal Sensitivity:

1 µV/graduation recommended

### A/D Sample Rate:

6.25 to 120 Hz, software selectable

### Resolution:

Internal: 8,000,000 counts  
Display: 1,000,000

### System Linearity:

Within 0.01% full scale

### Communication:

Ethernet TCP/IP  
USB Device

### Annunciators:

lb/kg

### Display:

Stainless steel, panel mounted, seven-digit LCD display, 0.8 in (20 mm) tall digits

### Keys/Buttons:

Zero, Units, Accum, Print, Enter

### Temperature Range:

14 °F to 104 °F (-10 °C to 40 °C)

### Dimensions:

Panel Mount Display:  
7.5 x 4.0 x 1.49 in  
(19.05 x 10.16 x 3.79 cm)  
External Mount Display:  
7.5 x 3.9 x 1.44 in  
(19.05 x 9.91 x 3.66 cm)  
Panel Mount Keypad:  
4.0 x 2.5 x 2.1 in  
(10.16 x 6.35 x 5.33 cm)  
CPU Enclosure:  
7.5 x 7.0 x 2.25 in  
without mounting feet  
11.13 x 7.0 x 3.06 in  
with mounting feet

### Weight:

5.25 lb

### Warranty:

Two-year limited

### Approvals:

NTEP 21-015, Class III/IIIL, 10,000d  
Measurement Canada AM-6168C  
cULus  
IEC

## Dimensions

### CPU Enclosure Assembly

A	7.30 in (18.55 cm)	F	11.10 in (28.20 cm)
B	7.00 in (17.78 cm)	G	2.40 in (6.10 cm)
C	3.20 in (8.13 cm)	H	10.00 in (25.40 cm)
D	8.00 in (20.32 cm)	I	4.50 in (11.43 cm)
E	7.50 in (19.05 cm)		

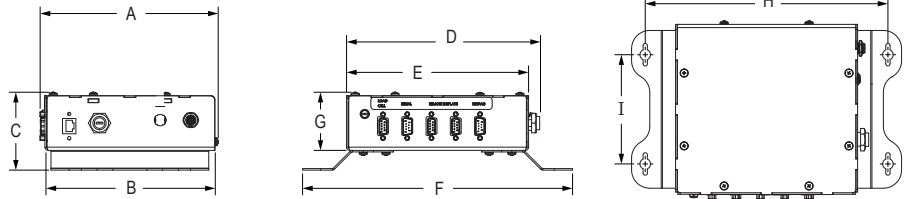

### Remote Keypad (Panel Mount)

A	4.00 in (10.16 cm)	E	1.90 in (4.83 cm)
B	2.50 in (6.35 cm)	F	1.38 in (3.51 cm)
C	1.98 in (5.03 cm)	G	4.63 in (11.76 cm)
D	0.063 in (0.16 cm)	H	2.60 in (6.61 cm)

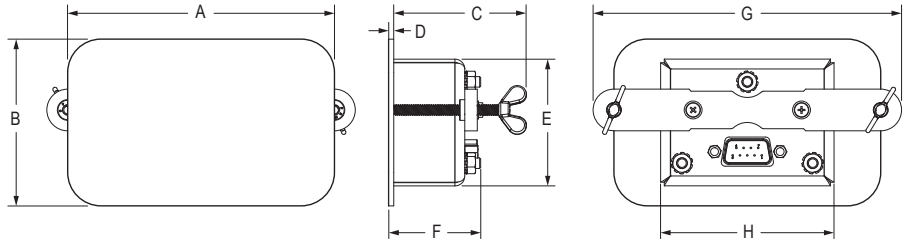

### Remote Display (Panel Mount)

A	7.50 in (19.05 cm)	E	1.00 in (2.54 cm)
B	4.00 in (10.16 cm)	F	0.06 in (0.16 cm)
C	7.00 in (17.78 cm)	G	1.33 in (3.38 cm)
D	2.22 in (5.64 cm)	H	1.49 in (3.79 cm)

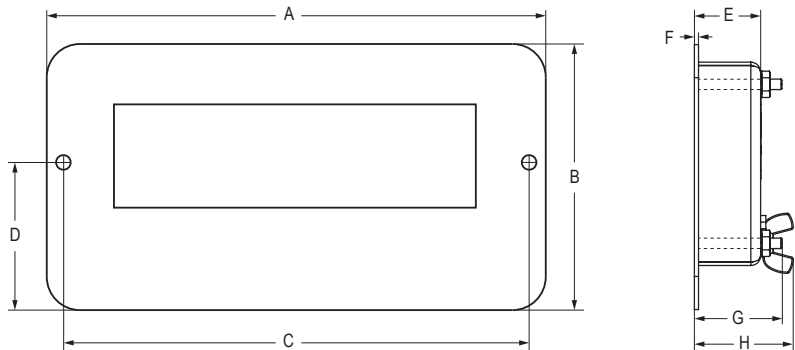

### Remote Display (External Mount)

A	7.50 in (19.05 cm)	E	1.44 in (3.66 cm)
B	3.90 in (9.91 cm)	F	1.29 in (3.28 cm)
C	6.22 in (15.80 cm)	G	1.00 in (2.54 cm)
D	1.95 in (4.96 cm)		

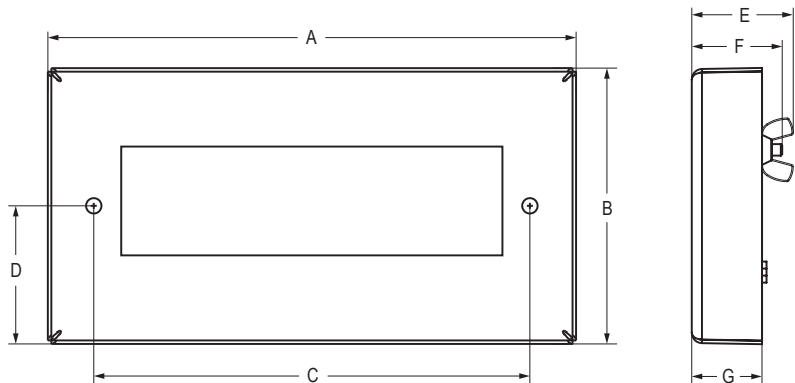

This image shows a full page of blank graph paper. The grid consists of small, uniform squares formed by thin, light gray lines. There are no margins, text, or other markings on the page.

