

**NEW**

Picture is a representation of actual product.

## Order Information

Load Rating	Part #	Est. Weight	Price
300 g	<b>227802</b>	3 lb	Consult
500 g	<b>227803</b>	3 lb	Consult
1,000 g	<b>227804</b>	3 lb	Consult
2,000 g	<b>227805</b>	3 lb	Consult
3,000 g	<b>227806</b>	3 lb	Consult
5,000 g	<b>227807</b>	3 lb	Consult

## Dimensions

Rated Capacity	A	B	C	D	E	F	G	H	I	J
kg/mm										
300 to 5,000	110.0	18.0	33.0	86.0	7.0	5.0	<3.0	10.0	4 × M3 × 0.5, 9 mm deep	0.5 m, 4 core cable, PVC

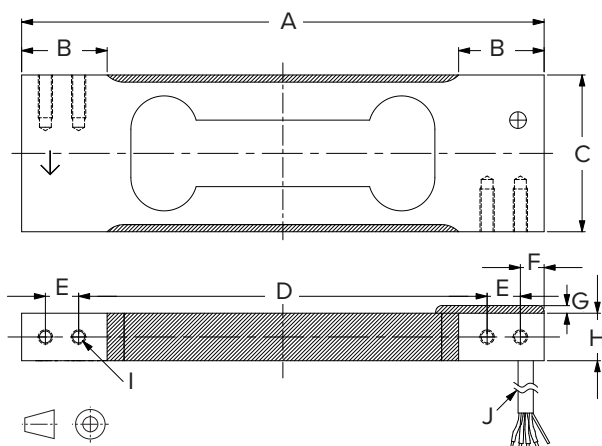

## Specifications

### Full Scale Output:

1 mV/V

### Output Resistance:

350 (± 10) ohm

### Input Resistance:

409 (± 15) ohm

### Material Finish:

Aluminum

### Temperature:

Compensated:

14 °F to 104 °F (-10 °C to 40 °C)

Operating:

0 °F to 150 °F (-18 °C to 65 °C)

### Seal Type:

Environmentally sealed, IP66

### Safe Overload:

150% full scale

### Rated Excitation:

5 to 10 VDC

### Combined Error:

± 0.05% full scale

### Insulation Resistance:

5,000 megohm

### Cable Length:

0.5 m

### Cable Jacket:

PVC

### Color Code:

Green +Excitation

Black -Excitation

White +Signal

Red -Signal

Yellow Shield

### Max Platform Size:

200 × 200 mm

### Warranty:

One-year limited