

RoughDeck® RP

Rodent Protection Floor Scale



Approvals



Part Number/Price

Part #	Size (W × L × H)	Capacity	Est. Weight	Price
195834	4 ft × 4 ft × 3.5 in	5,000 lb	375 lb	Consult
195835	4 ft × 4 ft × 3.5 in	10,000 lb	375 lb	Consult
195836	5 ft × 5 ft × 3.5 in	5,000 lb	541 lb	Consult
195837	5 ft × 5 ft × 3.5 in	10,000 lb	696 lb	Consult

Options/Accessories

Part #	Description	Price
18777	Floor anchor plates, mild steel (set of 2)	Consult

Standard Features

- Heavy-duty industrial design
- Structural steel channel frame
- Four NTEP Certified alloy steel, shear beam load cells
- 20 ft SURVIVOR® EL147RP rodent protection load cell cable with 1/2-inch conduit fitting (conduit for home run cable to be supplied by customer)
- Top-access junction box with additional top access cover for routing load cell cable into scale conduit
- Diamond safety tread plate deck
- Four adjustable stainless steel SUREFOOT™ support feet

Specifications

End Load Capacity:

- 100% full scale at 5,000 lb
- 80% full scale at 10,000 lb

Cable Length:

- 20 ft (6.1 m) for connecting junction box to indicator
- Note: 1/2 in conduit fitting supplied, conduit for home run cable to be supplied by customer

Junction Box:

- TuffSeal® JB4SS stainless steel, NEMA Type 4X junction box with signal trim card

Welding:

- Stitch

Threaded Eyebolt:

- Hole (1/2-20 NF) located in center of deck for easy lifting

Warranty (limited):

- Weldment: Five years
- Load cells: Two years
- All other components: One year

Approvals:

- NTEP 92-001, Class III 5,000d
- Load Cell is NTEP
- Load Cell is cFMus Approved

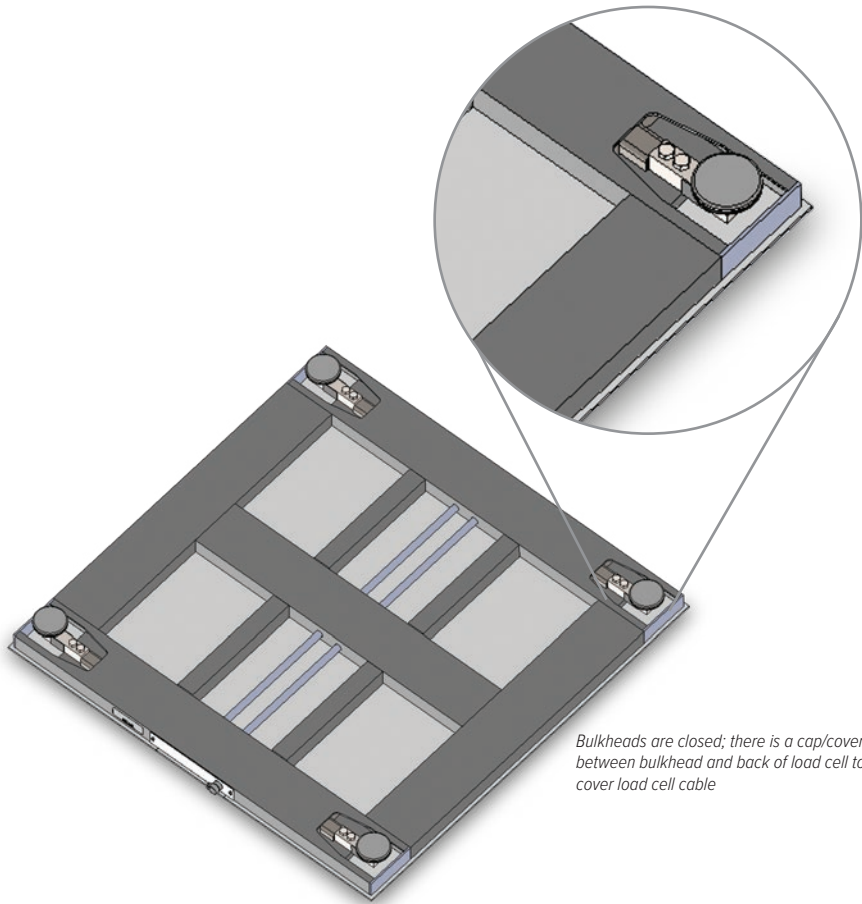

Bulkheads are closed; there is a cap/cover between bulkhead and back of load cell to cover load cell cable