

iQUBE³ Digital Diagnostic Junction Box

24 VDC Remote Power Supply Installation

This document contains procedures for installing the 24 VDC remote power supply. This power supply is recommended for use in iQUBE³ installations that do not have AC power available at the scale platform.



WARNING: Disconnect power before opening your supply enclosure.



CAUTION: Use a wrist strap to ground yourself and protect components from electrostatic discharge (ESD) when working with circuit boards.

This power supply provides a maximum of 50 watts with a maximum continuous current of 2.08 amps to power a full system over typical distances from scale-house to scale. The power supply is mounted in an 8 x 6 x 4-inch NEMA 4X FRP enclosure.

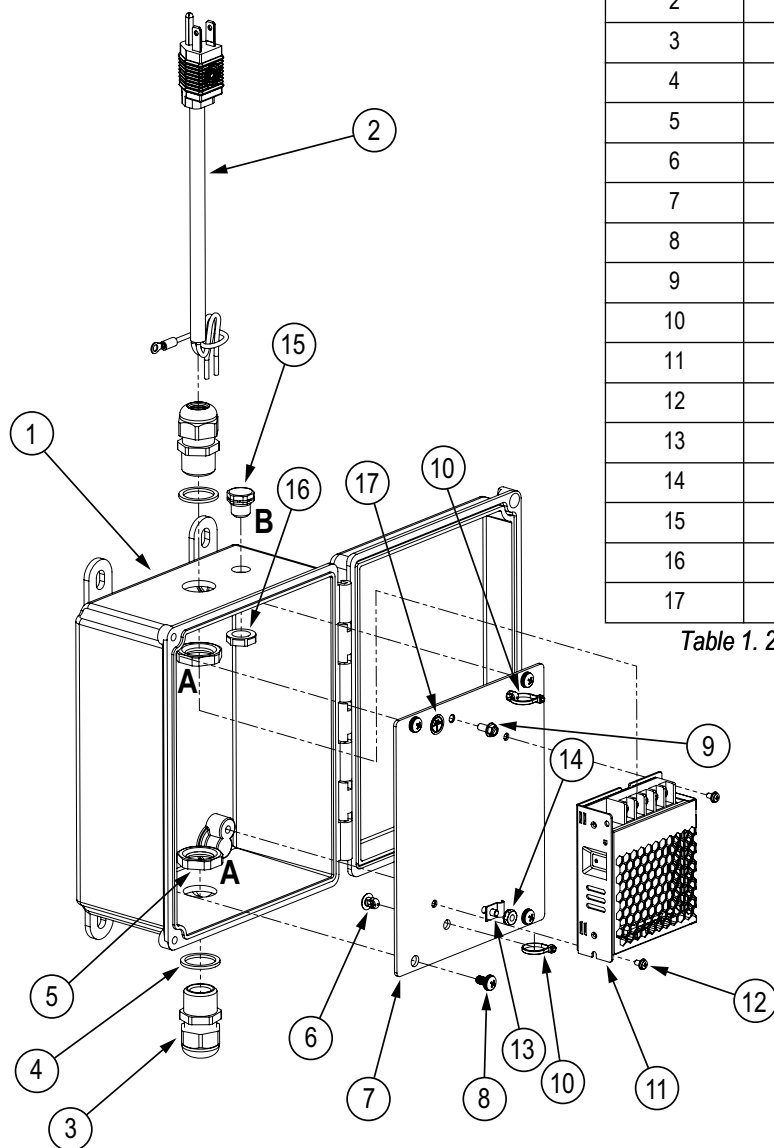

Number	PN	Description	Quantity
1	110496	Enclosure	1
2	180842	Power cord assembly	1
3	15628	Cord grip, 1/2 NPT	2
4	30376	Seal ring, 1/2 NPT	1
5	15630	Lock nut, 1/2 NPT	1
6	80589	Mount, Cable Tie Push In Reverse	2
7	227450	Back panel	1
8	109526	Machine screws, 10-32NC x 3/8	4
9	109529	Machine screw, 8-32NC x 3/8	1
10	15631	Cable ties	2
11	219056	24V power supply board	1
12	194487	Machine screws, M3-0.5 x 6	2
13	53075	Ground Cable Shield Clamp	1
14	14626	K-Lock Nut 8-32	1
15	88733	Breather Vent	1
16	88734	Breather vent nut, M12 x 1	1
17	16892	Earth/ground label	1

Table 1. 24 VDC Remote Power Supply Replacement Parts List

Figure 1. 24 VDC Remote Power Supply Replacement Parts



NOTE: Torque guidelines are as follows:

A. Cord Grip nuts tightened to 33 lb/in (see Figure 1 on page 1)

B. Vent Nut tightened to 10 lb/in (see Figure 1 on page 1)

The remote power supply is mounted using the four mounting holes. For mounting hole dimensions, see Figure 2.

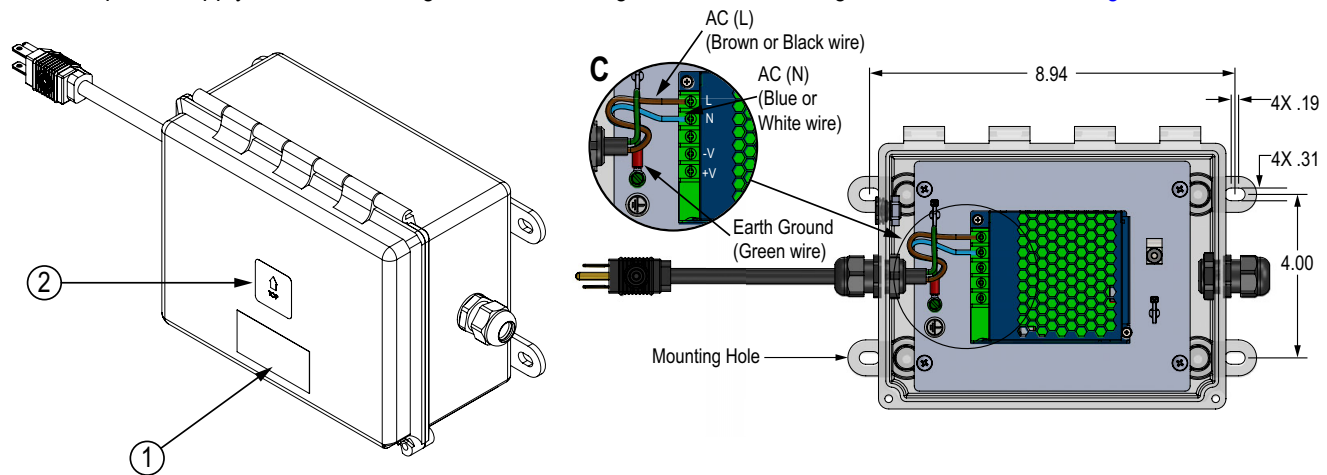

Figure 2. 24 VDC Remote Power Supply Replacement Parts

Number	PN	Description	Quantity
1	16861	High voltage warning label	1
2	53308	Label, 1.25 x 1.25 8000T	1

Table 2. Replacement Parts

Specifications

Enclosure	FRP, NEMA 4X 8 in x 6 in x 4 in
Input voltage:	90–265 VAC
Input current max:	0.95 A / 115 VAC 0.56 A / 230 VAC
DC output voltage:	24 V
Rated output current max:	2.08A
Rated power:	50W
Voltage adjustment range:	21.6–28.8 V
Line regulation:	± 0.5%
Operating temperature:	–30°C to +70°C (–22°F to 158°F)
Working humidity:	20% to 90% RH, non-condensing
Storage temperature:	–40°C to +85°C (–40°F to 185°F)
Storage humidity:	10% to 95% RH



© Rice Lake Weighing Systems Content subject to change without notice.

230 W. Coleman St. • Rice Lake, WI 54868 • USA USA: 800-472-6703 • International: +1-715-234-9171